



**INSTANT MATCH®**

## SDS236T Instant Match Transformer



## QUICK CONNECT GUIDE

 **Bluetooth®**  
WITH  
**Active Link**



# Bluetooth® wireless technology

A wireless Bluetooth connection may be used to allow the SDS236T (755.678) Whale Instant Match® transformer to communicate with the Mira Advance Flex Extra (J09N) shower without the use of a physical hardwired connection or external flow sensor to activate the pump. To set up the wireless connection, please follow the process below.



## Important Information



WARNING



Please read the following information before setting up a *Bluetooth®* wireless technology connection between the Whale Instant Match® transformer and Mira® Advance Flex Extra (J09N) shower:

- The electrical wiring must conform to EU wiring regulations BS7671:2008 Part 7 (17th Edition).
- The Bluetooth® function of the Whale Instant Match® transformer will **only work** with the Mira® Advance Flex Extra (J09N) shower.
- Previous Whale Instant Match® Wireless transformers **cannot be** connected wirelessly to the Bluetooth® wireless technology enabled Mira Advance Flex Extra Shower (J09N).
- Bluetooth® wireless technology enabled transformers can be easily identified by the blue test button.
- For optimum signal strength, mount the transformer within 5 metres of the shower within the same room.
- Locating the transformer outside of a 5 meter radius or in a different room can cause a communication breakdown between the transformer and shower, resulting in intermittent or complete failure to operate.
- The Bluetooth connection is only to be used where the transformer is installed in the bathroom with the shower. Where the transformer is installed in a boxing only plastic access panels are to be used.
- A hardwired connection must be established if a Bluetooth® wireless technology connection cannot be made between the shower and transformer.
- If any component or cord is damaged, it must be replaced by a qualified person to avoid a hazard.

# Set Up

## 1. Shower and Transformer settings

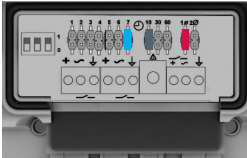
- Before starting the Bluetooth® pairing process, please ensure that the "BLE Pump Enable" or "Pump LK2" switch inside the front cover of the Mira® Advance Flex Extra (J09N) has been set to the "ON" position, and that the "Wired Pump Mode" or "Pump LK1" and "Reserved 2" or "Pump LK3" switches remain in the "OFF" position as per the diagram shown.
- At this stage, please ensure that your transformer is set to position 7 for "Bluetooth" and the pipe inlet diameter must be set to 1 for 15mm.



Blue Jumper - Sensor Position 7  
Grey Jumper - Over run 10 Seconds  
Red Jumper - Pipe inlet 15mm

	OFF	ON		
1			BEAB CARE MODE	BEAB
2			43 DEG C	43 DEG C
3			45 DEG C	45 DEG C
4			RESERVED 1	RESERVED
5			ECO	6L/MIN
6			RESERVED 2	PUMP LK3
7			BLE PUMP ENABLE	PUMP LK2
8			WIRED PUMP MODE	PUMP LK1

OR

Whale  
Transformer  
Settings

## Easy Pairing for Mira Advance Flex Extra J09N Manufactured after Week 2 2019 ie 02/19 on production date label located on base of shower.

### 2. Transformer set up

- Switch the mains electric supply to the transformer **ON** and wait to hear the audible beep from the transformer. The light on the transformer will now flash red to indicate that a Bluetooth® connection has not yet been established.
- Press and HOLD the blue test button on the transformer until the light flashes red and green to indicate that the transformer is now in pairing mode.

**NOTE:** You now have 120 seconds to pair the transformer to the shower.



### 3. Configuring the shower

- Turn on power to the shower using the pull cord.
- This will automatically pair the shower and pump.

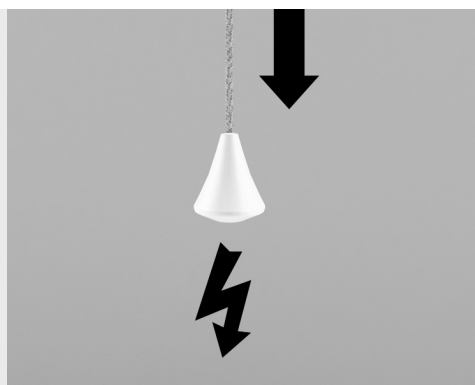

Skip to Page 7

# Pairing setup for Mira Advance Flex Extra J09N Manufactured prior to Week 2 2019

## 2. Transformer set up

- Switch the mains electric supply to the transformer **ON** and wait to hear the audible beep from the transformer. The light on the transformer will now flash red to indicate that a Bluetooth® connection has not yet been established.
- Press and HOLD the blue test button on the transformer until the light flashes red and green to indicate that the transformer is now in pairing mode.

**NOTE:** You now have 120 seconds to pair the transformer to the shower.



## 3. Shower set up

- Ensure that the electric supply to the shower is turned **OFF**. Then turn the dial on the shower to **FULL COLD**.



## 4. Configuring the shower

- Switch the mains electric supply to the shower **ON**, Start/Stop button will illuminate.
- Within **10** seconds press and HOLD the Start/Stop button on the shower until the Start/Stop light on the black button goes off.

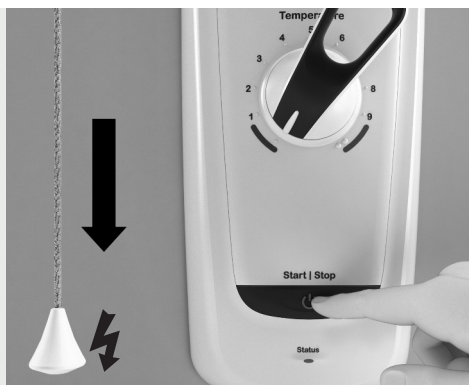

5. Slowly turn the dial on the shower to position 2

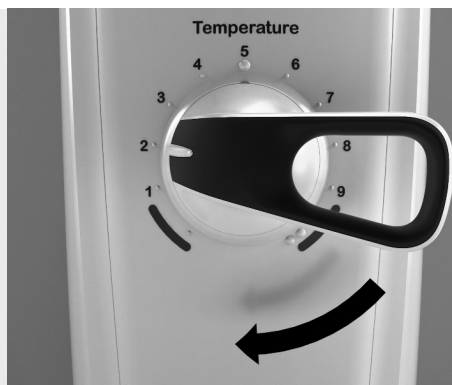

## 6. Pairing the shower to the Whale Instant Match® transformer

- Press and release the start/stop button on the shower.  
The status light on the shower will now flash **blue** to indicate that the shower is in pairing mode.
- The status light on the shower will then flash white and you will hear an audible beep from the shower to indicate that the transformer has successfully been paired to the shower.
- The Whale® transformer will flash green only to indicate that it is paired to the Mira® shower.

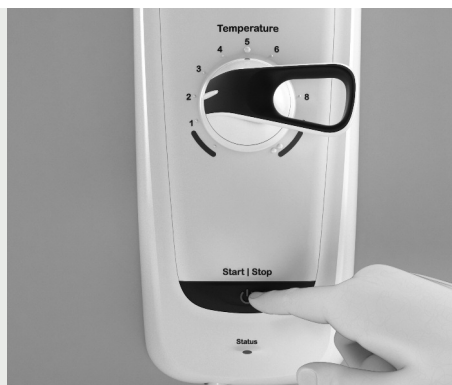

## 7. Completing the pairing

- Turn the temperature control to full cold and press the Start/Stop button on the shower. The shower will now return to normal standby mode.
- You may now follow the "Post Installation Procedure" in the Mira® Advance Flex Extra (J09N) Instruction Manual (page 25) if necessary.



## Bluetooth® wireless technology unpairing

Service work that may need to be carried out on the Mira® Advance Flex Extra (J09N) shower e.g. the renewal of the control PCB board may require the Bluetooth® wireless technology connection between the shower and Whale Instant Match® transformer to be terminated and paired again. To unpair the transformer from the shower, please follow these steps.

1. Switch the mains electric supply to the shower OFF

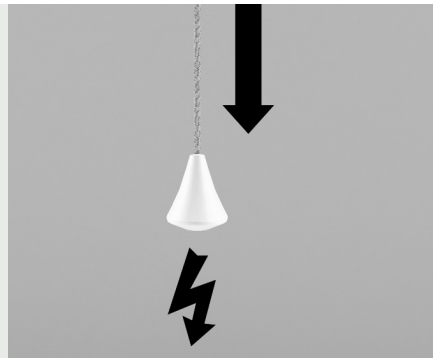

2. Be sure to leave the mains electric supply to the pump ON. The light on the transformer will flash blue

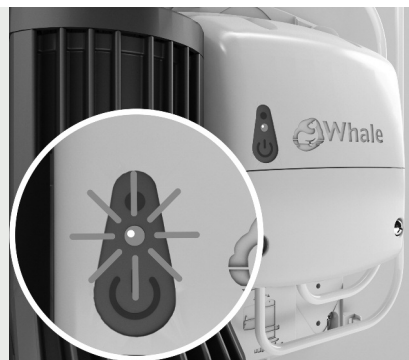

3. Press and HOLD the test button on the transformer until the light flashes red. The transformer and shower have now been unpaired

**NOTE:** To pair the shower to the transformer again, please follow the Bluetooth® wireless technology set up procedure.



# Bluetooth wireless technology unpairing Mira Advance Flex Extra (J09N)

In cases where the Mira shower needs to be paired to a new transformer or re-paired with an existing transformer, the following steps to unpair the shower must be taken.

## 1. Unpair transformer and shower

- Isolate power from Mira shower
- Remove front cover from Mira shower
- Move DIP switch 'BLE PUMP ENABLE' to 'OFF' position (see opposite)

OFF		ON	
1			BEAB CARE MODE
2			43 DEG C
3			45 DEG C
4			RESERVED 1
5			ECO
6			RESERVED 2
7			BLE PUMP ENABLE
8			WIRED PUMP MODE

## 2. Power cycle shower

- Replace front cover
- Turn power on to Mira shower

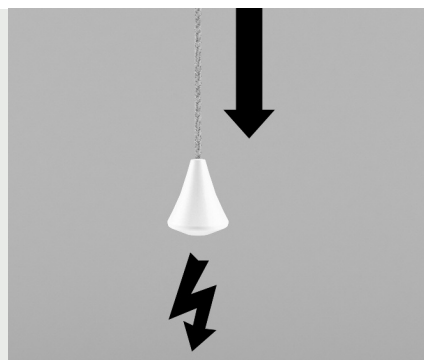

## 3. Pair transformer and shower

- Isolate power from Mira shower
- Remove front cover from Mira shower
- Move DIP switch 'BLE PUMP ENABLE' to 'ON' position (see opposite)
- Replace front cover
- The shower is ready to be paired with Whale transformer

OFF		ON	
1			BEAB CARE MODE
2			43 DEG C
3			45 DEG C
4			RESERVED 1
5			ECO
6			RESERVED 2
7			BLE PUMP ENABLE
8			WIRED PUMP MODE

# Whale Instant Match® Transformer Hardwired Connections

Where a Bluetooth® connection cannot be established between the transformer and shower, a hardwired connection may be used (on compatible showers) to activate the pump. The hardwired connection allows the transformer and shower to communicate by means of a physical wired connection, eliminating the need for an external flow sensor. Compatible showers and their pump connections may be found below.

## Mira® Advance Flex Extra 1.1785.005 (J09N)

Wired Connections to the Whale Instant Match® Transformer

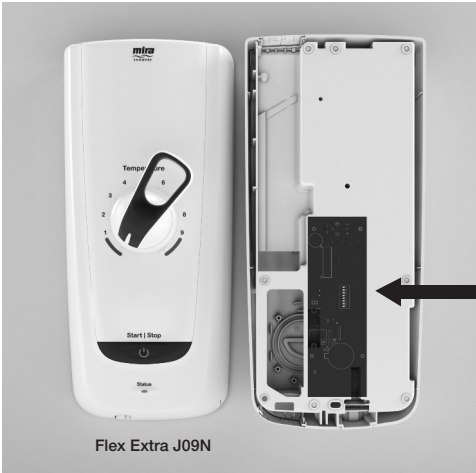

Ensure all LK settings are set to 'OFF' for hardwired connection

OFF	ON	
1	<input type="checkbox"/>	BEAB CARE MODE
2	<input type="checkbox"/>	43 DEG C
3	<input type="checkbox"/>	45 DEG C
4	<input type="checkbox"/>	RESERVED 1
5	<input type="checkbox"/>	ECO
6	<input type="checkbox"/>	RESERVED 2
7	<input type="checkbox"/>	BLE PUMP ENABLE
8	<input type="checkbox"/>	WIRED PUMP MODE

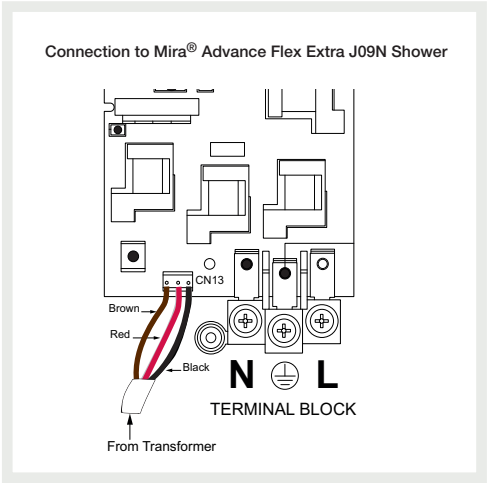
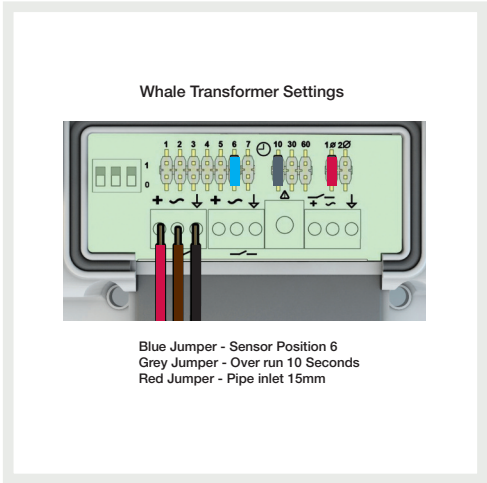

# Whale Instant Match® Transformer Hardwired Connections Cont'd

Triton® Safeguard +  
 Omnicare Design,  
 Omnicare Style, T150Z+

Wired Connections to  
 the Whale Instant  
 Match® Transformer



## Triton® Shower Connections and Settings

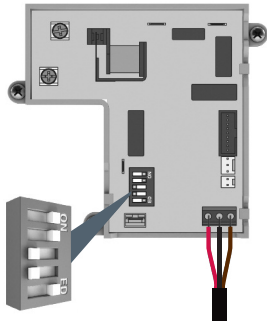

### Whale® Transformer Settings

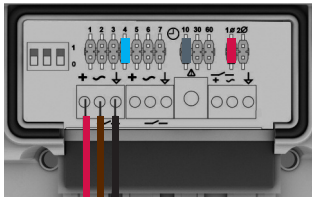

Blue Jumper - Sensor Position 4  
 Grey Jumper - Over run 10 Seconds  
 Red Jumper - Pipe inlet 15mm

Redring® Selectronic WP  
 (SEL85WP or SEL95WP)

Wired Connections to the Whale  
 Instant Match® Transformer



## Redring® Shower Connections and Settings

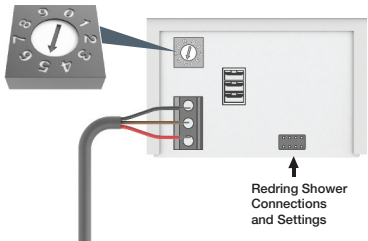

Redring Shower  
 Connections  
 and Settings

### Whale® Transformer Settings

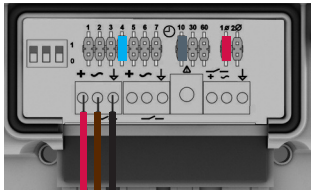

Blue Jumper - Sensor Position 4  
 Grey Jumper - Over run 10 Seconds  
 Red Jumper - Pipe inlet 15mm

# Whale Instant Match® Transformer Flow Sensor Connections

An external flow sensor should be used where a shower is not compatible with a Bluetooth® wireless technology or hardwired connection to activate the pump. Compatible flow sensors and their connections to the transformer are listed below.

## Sika® Sensor Connection

### Whale® Transformer Settings

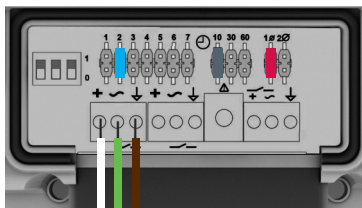

Blue Jumper - Sensor Position 2  
Grey Jumper - Over run 10 Seconds  
Red Jumper - Pipe inlet 15mm



**Sika® Sensor**

Please ensure that water flow through the sensor is in the direction of the arrow on the sensor.

## Gems® Sensor Connection

### Whale® Transformer Settings

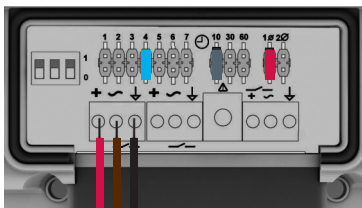

Blue Jumper - Sensor Position 4  
Grey Jumper - Over run 10 Seconds  
Red Jumper - Pipe inlet 15mm

There are two versions of Gems® flow sensor: 1000 pulses per litre (ppl) and 2200 ppl. Blue jumper position 3 = 1000 ppl. Blue jumper position 4 = 2200 ppl (shown below)

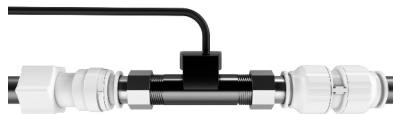

**Gems® Sensor**

Please ensure that water flow through the sensor is in the direction of the arrow on the sensor.

## Grundfos® (Venturi) Connection

When connecting to the Grundfos® Venturi sensor it is important to connect an earth wire from the Venturi sensor to the signal earth connection on Whale® transformer (shown below).

### Whale® Transformer Settings

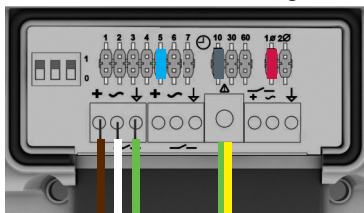

Blue Jumper - Sensor Position 5  
Grey Jumper - Over run 10 Seconds  
Red Jumper - Pipe inlet 15mm

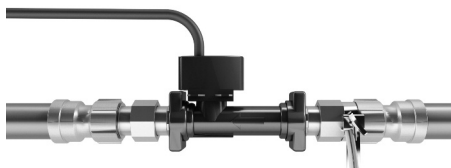

**Venturi® sensor**

Please ensure that water flow through the sensor is in the direction of the arrow on the sensor.

# Whale Instant Match® Transformer Flow Switch Connections

In a situation where a Bluetooth® wireless technology or hardwired connection with the shower cannot be established, or a suitable flow sensor has not been fitted, the Whale SDS236T Instant Match transformer can be used with an AK1568 flow switch to activate the pump.

## Electric Shower Settings

- Step 1: Turn Dip switch 2 to the 'ON' position.
- Step 2: Move red jumper to pipe size '1' for 15mm inlet pipe.
- Step 3: Move the blue jumper to increase or decrease the pump speed as required, using the table below as a guide.
- Step 4: Move the grey jumper to increase or decrease the pump overrun if necessary.

Jumper Position	Flow Rate (LPM)
1.	4.5 - As shown opposite
2.	5.0
3.	5.5
4.	6.0
5.	6.5
6.	7.0
7.	7.5

- Flow rates are nominal values only.  
This will vary depending on pipework.



Please ensure that water flow through the sensor is in the direction of the arrow on the sensor.

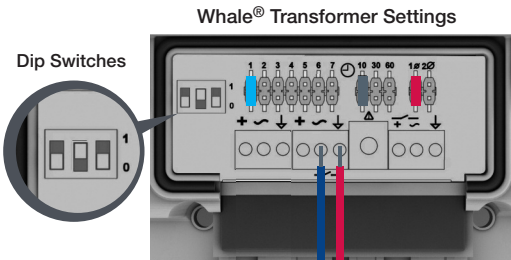

# Whale Instant Match® Transformer Flow Switch Connections Cont'd

## Mixer Shower Settings

- Step 1: Turn Dip switch 2 to the 'ON' position.
- Step 2: Move red jumper to pipe size '2' for 22mm inlet pipe.
- Step 3: Move the blue jumper to increase or decrease the pump speed as required, using the below table as a guide.
- Step 4: Move the grey jumper to increase or decrease the pump overrun if necessary. 30 is the recommended setting for use on mixer showers.

Note: An additional flow switch is available in the AK1570 Mixer Valve Conversion kit (sold separately).

Flow Switch x 2



Please ensure that water flow through the sensor is in the direction of the arrow on the sensor.

Jumper Position	Flow Rate (LPM)
1.	7.5 - As shown opposite
2.	8.0
3.	8.5
4.	9.0
5.	9.5
6.	10.0
7.	11.0

- Flow rates are nominal values only. This will vary depending on pipework.

Whale® Transformer Settings

Dip Switches

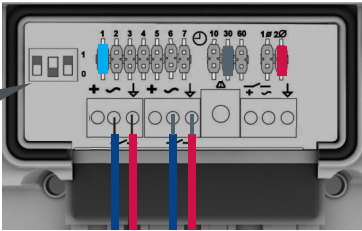
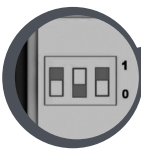

- Blue Jumper - Sensor Position 1  
Grey Jumper - Over run 30 Seconds  
Red Jumper - Pipe inlet 22mm



©Copyright Whale 2019 - All rights reserved. Reproduction in whole or in part without permission is prohibited. WHALE® and WHALE INSTANT MATCH® are registered trademarks of Munster Simms Engineering Limited, Bangor, Northern Ireland trading as Whale. Whale's policy is one of continuous improvement and we reserve the right to change specifications without prior notice. Illustrations are for guidance purposes only. Neither the accuracy nor completeness of the information contained in this or any product literature is guaranteed by the Company and may be subject to change at its sole discretion.

The Bluetooth® word mark and logos are registered trademarks owned by Bluetooth SIG, Inc. and any use of such marks by Munster Simms Engineering Ltd (trading as Whale) is under licence. Other trademarks and trade names are those of their respective owners.

MIRA® is a registered trade mark of Kohler Mira Limited.

TRITON® is a registered trade mark of Triton Showers a division of Norcros Group (Holdings).

REDRING® is a registered trade mark of Redring Xpelair Group Limited.

SIKA® is a registered trade mark of Dr. Siebert & Kuhn GmbH & Co. KG

GEMS® is a registered trademark of Gems Sensors & Controls.

GRUNDFOS® is a registered trademark owned by Grundfos Management A/S or Grundfos A/S, Denmark.



0345 9090 912



[drainagesupport@whalepumps.com](mailto:drainagesupport@whalepumps.com)



[www.whalepumps.com](http://www.whalepumps.com)



@Whalecare



**Whale, 2 Enterprise Road,  
Bangor, Co. Down,  
BT19 7TA, N.Ireland**

Ref. 182.606\_v4\_1019