



**Pressalit Raja 410**  
**Toilet seat with soft close and lift-off incl. universal hinge in stainless steel**

**Features**

Lift-off, Soft close

**Item number**

410000-BL5999  
 EAN:5708590212159

Our designer found inspiration in the rays (all members of this species of fish have Raja as their first name - in Latin), and the Raja toilet seat is just as grand and elegant as its living pattern. The unique form and ample dimensions make the seat sort of float above the pan. It looks great - and it means that the Raja suits most pans. The seat has soft close and lift-off function for easy cleaning.



**Colour**

White

**Description**

PRESSALIT toilet seat with cover, model "Raja", art. no. 410 made of colour ingrained duroplast with BL5 universal hinge for lift-off in stainless steel.

- built-in soft close function
- centre distance: 95-170 mm
- load - ring seat 300 kg
- removable seat/cover facilitates cleaning
- suitable for many universal toilets
- 10 year guarantee

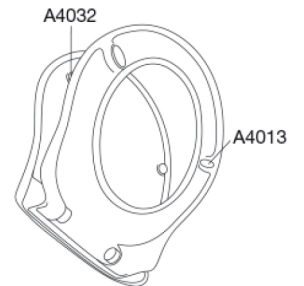
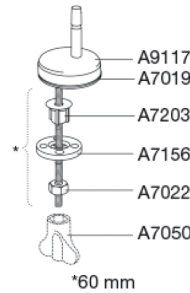
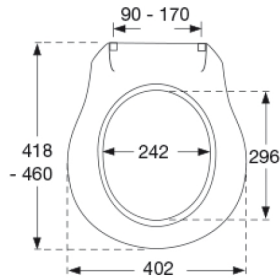

**Design type**

Sandwich

**Designer**

Pressalit

**Design year**

2003



---

**Pressalit Raja 410**  
**Toilet seat with soft close and lift-off incl. universal hinge in stainless steel**

---

**Materials**

**TOILET SEAT:**

The material is colour ingrained duroplast (UF A 10 = urea formaldehyde) that contains no environmentally hazardous substances. UF plastic comprises 67% urea formaldehyde resin, 28% cellulose, as well as 5% minerals, pigments, lubricants and moisture content. The raw material from the supplier contains up to 0.03% free formaldehyde and even less following curing.

**BUFFERS:**

EVA (copolymer made of ethylene and vinyl acetate).

**DAMPER KIT (only relevant for toilet seats with soft close):**

Hydraulic damper with stainless steel damper casing and thermoplastic parts.

**MOUNT/HINGES:**

Stainless steel model W. no. 1.4301/M and thermoplastic.

**Product capacity**

Load - ring seat 300 kg

---

**Weight**

3,57 kg

**Carton size**

524x428x82 mm

**Gross weight**

4,17 kg

**Weight per crate**

4,17 kg

**Qty per crate**

1

**Crates per pallet**

40

**Qty per pallet**

40

**Cleaning**

Use a mild soap solution to clean the seat. Please take care that the seat and hinges are not left damp. Dry off any residual water or cleaning agent with a soft cloth. Avoid contact of the seat and hinges with abrasive, corrosive or chlorine-based cleaners, as these may cause damage or lead to flash rust. Therefore, when cleaning the bowl, make sure that the seat and cover are kept in an upright position until all cleaning agent has been flushed away.

**Warranty**

Your Pressalit toilet seat is subject to a 10-year product warranty against presentation of receipt. You should contact the dealer or store where you purchased the seat in the event of a complaint.  
  
In the event of complaints about defective materials and/or manufacturing defects and/or functional limitations ascertained within a 10-year period, following proper use and cleaning of the toilet seat (we reserve the right to examine the toilet seat at our factory), Pressalit will deliver spare parts or replace the toilet seat by an identical or similar model. If the color is no longer available, Pressalit reserves its right to replace the toilet seat by a similar model in the color white. Upon replacement or delivery of a spare part, the warranty period will not be extended nor renewed. If replacement is not possible, Pressalit may instead refund the purchase price.



PRESSALIT®

---

**Pressalit Raja 410**  
**Toilet seat with soft close and lift-off incl. universal hinge in**  
**stainless steel**

---

Subject to changes in the product range, technical changes and printing errors.

---

[pressalit.com](http://pressalit.com)

---

Pressalit A/S  
Pressalitvej 1  
DK-8680 Ry  
Tel.: +45 8788 8788  
Fax: +45 8788 8789  
E-mail: [pressalit@pressalit.com](mailto:pressalit@pressalit.com)

PRESSALIT®