

GEBERIT AQUACLEAN 4000

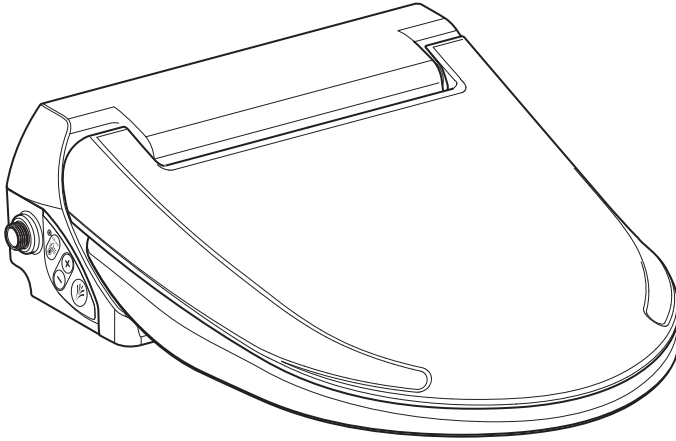

# USER MANUAL



965.453.00.0(03)



# Table of contents

---

<b>For your safety</b> .....	<b>5</b>
Who is this product suitable for? .....	5
How is this product used? .....	5
What should you avoid? .....	5
Misuse .....	5
General safety notes .....	6
Explanation of warning notes .....	7
Overview of symbols on the product .....	7
<b>Register your device</b> .....	<b>8</b>
<b>Getting to know your device</b> .....	<b>9</b>
About Geberit AquaClean devices .....	9
Functional overview .....	9
The device at a glance .....	10
<b>Operating concept</b> .....	<b>11</b>
About the operating concept .....	11
Lateral control panel .....	11
Status LED on the lateral control panel .....	11
WC seat ring and lid with soft-closing mechanism .....	12
<b>How to use the device</b> .....	<b>12</b>
Using the anal shower .....	12
Switching the storage water heater function on and off .....	12
<b>Adjusting the shower procedure to your personal needs</b> .....	<b>13</b>
Set the spray intensity .....	13
<b>Cleaning and descaling the device</b> .....	<b>14</b>
Care Instructions .....	14
General cleaning recommendations .....	14
Targeted disinfection .....	14
Suitable cleaning agents and cleaning equipment .....	15
Care instructions for smooth surfaces .....	17
Care instructions for sanitary ceramic appliances .....	17

Care instructions for WC seat .....	18
Cleaning the WC lid, WC seat ring and housing .....	18
Clean the spray nozzle.....	20
Clean or replace the basket filter.....	22
Replacing the compensation pads .....	23
Empty the storage water heater .....	23
<b>Troubleshooting .....</b>	<b>24</b>
The shower toilet is without function .....	24
Other functional errors.....	26
<b>Sustainability .....</b>	<b>28</b>
Geberit Group and sustainability .....	28
Ecodesign – ecobalance .....	28
Tips for reducing the ecological footprint.....	28
<b>Disposal .....</b>	<b>29</b>
Disposal of waste electrical and electronic equipment.....	29
<b>End user warranty .....</b>	<b>30</b>
<b>Technical data and conformity .....</b>	<b>31</b>
Technical data .....	31
Simplified EU Declaration of Conformity .....	31
Simplified UK Declaration of Conformity .....	31

## For your safety

---

### Who is this product suitable for?

As a functioning toilet, the Geberit AquaClean shower toilet is suitable for all age groups. However, children must not carry out cleaning or maintenance work without supervision.

### How is this product used?

The product is suitable for the following application purposes and areas of use:

- as a shower toilet:
  - for cleaning the anal area
- for installation in heated indoor areas
- for connection to the drinking water system
- for operation with water from reverse osmosis systems

### What should you avoid?

The product must be used as intended. Do not:

- use aggressive and scouring cleaning agents that can damage the surface
- place loads or objects on the WC lid
- stand on the WC lid or WC seat ring

### Misuse

Geberit accepts no liability for the consequences arising from misuse.

## General safety notes

The following safety notes apply for the entire duration of the product's life cycle:

- Read the user manual before the first use to familiarise yourself with the use of the product.
- Store the user manual for future reference.
- Do not use the device if it is damaged. If possible, isolate the device from the supply system and contact Geberit customer service.
- Do not open the device. It does not contain any components for the user to service or repair.
- Do not perform any changes or additional installations. Modifying the device runs the risk of fatal danger.
- Repairs may only be carried out by authorised skilled persons using original spare parts.
- Only original accessories may be used.
- Operation and maintenance work may only be performed by the operator or user as described in this user manual.
- Always use the current version of the installation manual for installing the device if the Geberit AquaClean has been removed (e.g. if you move house).
- The Geberit AquaClean must only be connected to a mains voltage conforming to the specification plate.
- Observe the manufacturer information at all times regarding the use of cleaning and descaling agents.

---

**i** This document contains warning notes at various points. Warning notes are usage and situation-specific safety notes. They provide warnings on specific hazards.

---

**i** These instructions correspond to the state of the device technology at the time of printing. Geberit reserves the right to make changes in terms of further development.

A current version of this and other documents is available online: [www.geberit.com](http://www.geberit.com).

## Explanation of warning notes

Warning notes are placed at the location at which the hazard may occur.

Warning notes are structured as follows:



### **WARNING**

#### **Nature and source of the hazard**

Possible consequences if the hazard is ignored.

- ▶ Measures to prevent the hazard.

The following signal words are used to indicate residual hazards in warning notes and important information.

Symbol	Signal word and meaning
	<b>DANGER</b> The signal word denotes a hazard with a high degree of risk which, if not avoided, will result in death or serious injury.
	<b>ATTENTION</b> The signal word denotes a hazard, which, if not avoided, may result in material damage.
	Symbol only. Refers to important information.

## Overview of symbols on the product

Symbol	Meaning
	Read the safety notes and operating instructions/ operation manual before commissioning the product.
	Danger of fatal electric shock

# Register your device

---

## Warranty registration

Extend the warranty period of your Geberit AquaClean for free. Register for this within 90 working days from the installation date.



In the third year of the warranty period, Geberit shall supply spare parts free of charge in the event of any material or manufacturing faults, provided the product has been installed and put into operation by an installation company.

By computer: <http://www.geberit-aquaclean.com/registration>

By post: Fill out the warranty card supplied and send it to us.

By smartphone or tablet:





# Getting to know your device

---

## About Geberit AquaClean devices

The Geberit AquaClean device is a WC with integrated shower function. The device also fulfils all the functions of a conventional WC. Additional functions are subject to the design of your product.

## Functional overview

Hygiene functions:

- for gentle cleaning of the anal area with water
- automatic spray nozzle cleaning before and after each shower procedure

Comfort functions:

- spray intensity can be selected
- WC seat ring and WC lid with SoftClosing
- ergonomic lateral control panel

Cleaning and care:

- removable WC lid

## The device at a glance

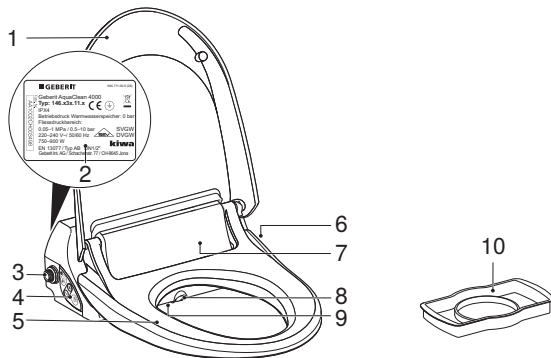

- 1 WC lid
- 2 Specification plate with serial number
- 3 Basket filter
- 4 Lateral control panel with status LED
- 5 WC seat ring
- 6 Mains connection cable with plug
- 7 User recognition
- 8 Spray arm with spray nozzle
- 9 Drain screw
- 10 Spray shield

# Operating concept

## About the operating concept

The Geberit AquaClean shower toilet can be operated using the lateral control panel.

## Lateral control panel

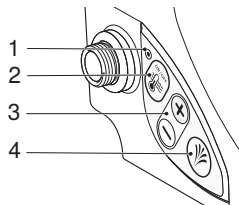

- 1 Storage water heater LED display
- 2 <Storage water heater function> button: economy mode/ON/OFF
- 3 <+>/<-> buttons: increase or decrease the spray intensity
- 4 <Shower> button: start and stop shower

## Status LED on the lateral control panel

LED	Meaning
Flashes blue (switching to economy mode)	<b>Economy mode</b> In economy mode (factory setting), the heating element only switches on if user recognition is activated. The warm-up time is 2 to 3 minutes.
Lights up blue	<b>ON</b> Heating element is switched on.
Does not light up	<b>OFF</b> Heating element is switched off or economy mode is switched on and user recognition is not activated.
Flashes red	Malfunction message → See "Troubleshooting", page 24

## WC seat ring and lid with soft-closing mechanism

- i** Dampers cushion the WC seat ring and lid noiselessly and slow down closing. The seat ring and lid open just like on any normal WC.

- ▶ Do not press the WC seat ring and lid down with your hand. This will damage the dampers.

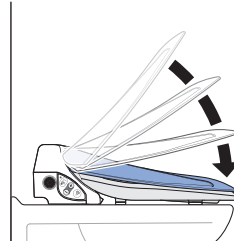

## How to use the device

### Using the anal shower

#### Prerequisite

- You are sitting down on the WC seat ring.

- ▶ Briefly press the <Shower> button on the lateral control panel.

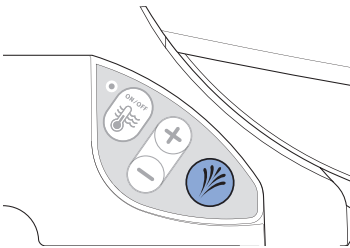

#### Result

- ✓ The shower procedure starts and stops after 20 seconds.

- i** You can stop the shower procedure early by pressing the <Shower> button once again.

### Switching the storage water heater function on and off

- ▶ Press the <Storage water heater function> button repeatedly until the LED on the control panel shows the desired status (economy mode/ON/OFF).

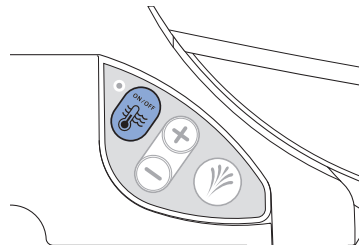

#### Result

- ✓ The LED on the control panel indicates whether the storage water heater function is switched on or off or whether it is set to user recognition (economy mode). → See "Status LED on the lateral control panel", page 11.

# Adjusting the shower procedure to your personal needs

---

## Set the spray intensity

### Prerequisite

- The shower procedure is running.
- 

- ▶ Press the <+> button to increase the spray intensity. Press the <-> button to decrease the spray intensity.

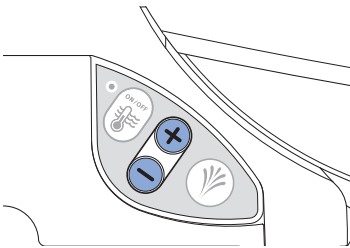

### Result

- ✓ The shower spray becomes stronger/weaker.
- 

- i** You can set the spray intensity in 5 stages.

# Cleaning and descaling the device

---

## Care Instructions

You have selected a product with a high-grade surface. Please follow the care instructions below.

The manufacturer does not assume any liability for product damage that arises as a result of incorrect care and handling.

## General cleaning recommendations

Cleaning the shower toilet at the recommended cleaning intervals will ensure that it functions properly. The shower toilet must only be cleaned using suitable cleaning agents and cleaning equipment. → See "Suitable cleaning agents and cleaning equipment", page 15.

Cleaning interval	Cleaning activity
Daily	<ul style="list-style-type: none"><li>▶ Remove water drops with a soft, lint-free cloth to avoid limescale stains.</li></ul>
Weekly	<ul style="list-style-type: none"><li>▶ Clean the ceramic pan with Geberit AquaClean cleaning agent. → See "Care instructions for sanitary ceramic appliances", page 17.</li><li>▶ Clean all surfaces and corners thoroughly. → See "Cleaning the WC lid, WC seat ring and housing", page 18.</li><li>▶ Test spray nozzle and clean if required. → See "Clean the spray nozzle", page 20.</li><li>▶ Rinse the spray nozzle under running water to remove foreign substances.</li></ul>

## Targeted disinfection

Disinfection is only required if there is a definite risk of infection as a result of germs. Otherwise, keep to the recommended cleaning intervals and carry out the specified cleaning activities. → See "General cleaning recommendations".

---

**ATTENTION****Aggressive disinfectants**

Disinfection using aggressive disinfectants can cause surface damage.

- ▶ Only use alcohol-based disinfectants that are also suitable for hand and skin disinfection.
- ▶ Observe the safety notes from the manufacturer when handling hazardous substances.

Type of disinfection	Disinfection procedure
<b>Wet wipe disinfection</b> For use on smooth surfaces that can be rubbed	<ul style="list-style-type: none"><li>▶ Moisten all surfaces with disinfectant.</li><li>▶ Allow the disinfectant to take effect according to the manufacturer information.</li><li>▶ Then rub the surfaces with single-use towels.</li></ul>

---

**Suitable cleaning agents and cleaning equipment**

---

**ATTENTION****Aggressive descaling agents**

Unsuitable descaling agents may cause damage to the device.

- ▶ Only use Geberit AquaClean descaling agents to descale the device.
- ▶ Refer to the “Descaling the device” section.

---





**ATTENTION****Aggressive and scouring cleaning agents**



Cleaning using aggressive and scouring cleaning agents can cause surface damage.

- ▶ Use Geberit AquaClean cleaning agents.
- ▶ Pay attention to the cleaning and care instructions.

Using the Geberit AquaClean cleaning set is recommended, as this set includes a ready-made cleaning agent that is ideal for cleaning all Geberit AquaClean surfaces.

Recommended properties of suitable cleaning agents and cleaning equipment for best cleaning results:

Symbol	Properties of suitable cleaning agents
	Skin-friendly
	Cleaning agents are permitted to have a low acid content, e.g. diluted citric acid
	Low-foaming
	Liquid
	Water-dilutable

Symbol	Suitable cleaning equipment
	Soft, fine-pored sponges
	Lint-free, soft cloths which are free of dust
	Toilet brush



## Care instructions for smooth surfaces

All smooth surfaces can be cleaned hygienically with water and a mild, liquid cleaning agent that is kind to the skin.

- i** Aggressive and scouring cleaning agents can damage the surface. Only use mild, liquid cleaning agents that are kind to the skin. The Geberit AquaClean cleaning set (art. no. 242.547.00.1) includes a ready-made cleaning agent that is optimal for cleaning all Geberit AquaClean surfaces.

## Care instructions for sanitary ceramic appliances

- Use standard cleaning agents only in compliance with the respective manufacturer's information.
- Ensure that the seat of the ceramic appliance or the urinal lid is opened or dismantled during the application time of cleaning agents.
- Only use cleaning agents containing chlorine or ones that are abrasive or scouring in the case of heavy deposits.
- Never use sharp or pointed objects when cleaning.

Dirt	Care measures
For daily cleaning	<ul style="list-style-type: none"><li>▶ Use mild liquid cleaning agents and water.</li><li>▶ Dry the surface with a soft, lint-free cloth.</li></ul>
Stubborn stains	<ul style="list-style-type: none"><li>▶ Generally speaking, use cleaning agents suitable for ceramic appliances or a mild scouring liquid.</li><li>▶ Remove existing limescale deposits using a mild cleaner containing vinegar.</li><li>▶ Clean the surface with water.</li><li>▶ Dry the surface with a soft, lint-free cloth.</li></ul>
With heavy deposits	<p>Organic deposits (brown to black in colour):</p> <ul style="list-style-type: none"><li>▶ Clean the affected areas with a standard chlorine cleaner. Note the information provided by the cleaning agent manufacturer. The application time of the chlorine cleaner may not exceed 2 h.</li><li>▶ Clean the surface with water.</li><li>▶ Dry the surface with a soft, lint-free cloth.</li></ul> <p>Silicate deposits (grey in colour):</p> <ul style="list-style-type: none"><li>▶ Moisten a microfibre cloth with standard ceramic glass cleaner.</li><li>▶ Clean the affected areas with in a circular motion. Silicate deposits are very resistant, which means that several cleaning cycles may be required.</li><li>▶ Clean the surface with water.</li><li>▶ Dry the surface with a soft, lint-free cloth.</li></ul>

## Care instructions for WC seat

Please note the following when cleaning the WC seat:

- Ensure that the WC seat is opened or dismantled during the application time of cleaning agents.
- Never use cleaning agents that contain chlorine or acid or that are corrosive.
- Never use cleaning agents that are abrasive or may scratch the surface.
- Never use sharp or pointed objects when cleaning.
- Use mild liquid cleaning agents and water.
- Use a soft, lint-free cloth.
- Remove any substances containing solvents immediately.

## Cleaning the WC lid, WC seat ring and housing

**i** Be careful not to scratch the surface of the WC seat. Always place the components on a soft, non-scratching underlay.

**1** Spray the surfaces with Geberit AquaClean cleaning agent. Wipe the surfaces with a soft, lint-free, damp cloth.

**2** Open the lid and turn the lid retainer upwards.



**3** Lift the WC lid off and pull it from the right hinge pin.

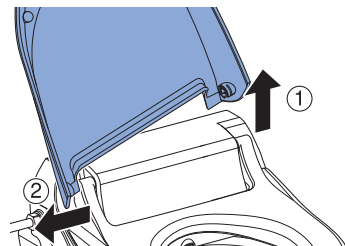

- 4** Remove the left hinge pin and pull the WC seat ring slightly forward.

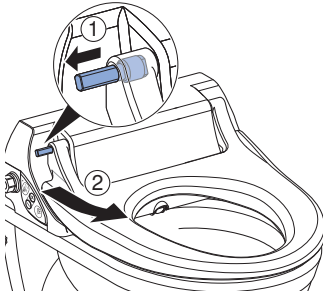

- 5** Pull the WC seat ring from the right hinge pin and remove it.

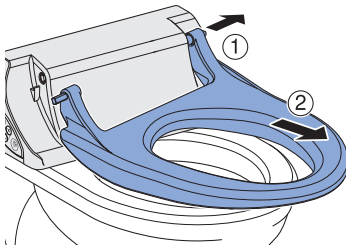

- 6** Spray the WC lid and the WC seat ring with Geberit AquaClean cleaning agent. Wipe the surfaces with a soft, lint-free, damp cloth.

- 7** Then dry all surfaces with a soft, lint-free cloth.

- 8** Slide the cleaned WC seat ring onto the right hinge pin.

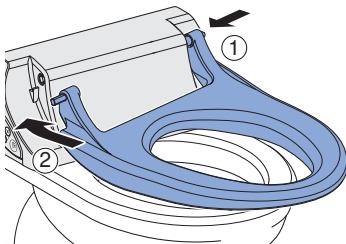

- 9** Push in the left hinge pin and let it snap into place by turning it.

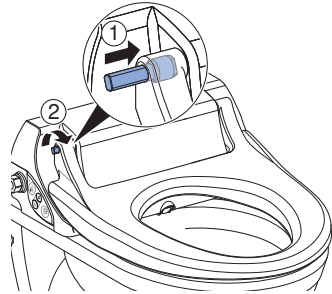

- 10** Slide the cleaned WC cover onto the left hinge pin and put it back in place on the right-hand side.

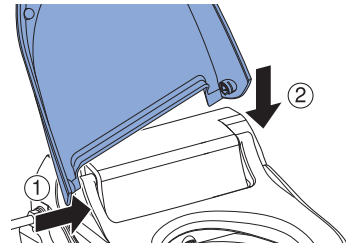

- 11** Turn the lid retainer downwards and close the WC lid.

## Clean the spray nozzle

- i** For cleaning, use a soft, lint-free cloth.
- Geberit AquaClean cleaning agent is particularly suitable for all surfaces of the device.

**1** Lift up the WC lid and the WC seat ring.

**2** Press the <+> and <-> keys or the <+> and <Shower> keys on the lateral control panel simultaneously.

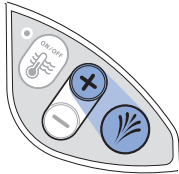
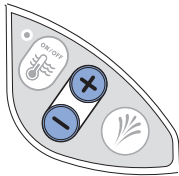

- ✓ The spray arm extends without spraying any water.

**3** Hold the spray arm firmly and remove the spray nozzle from the front to clean and descale it. Always ensure that the spray nozzle moves parallel to the spray arm.

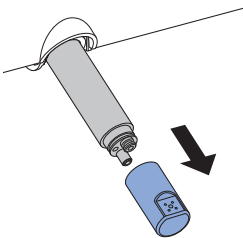

**4** Replace the spray nozzle if it can no longer be completely cleaned and descaled.

**5** Spray the spray arm with Geberit AquaClean cleaning agent. Then rinse it thoroughly with warm water.

**6** Dry the spray nozzle carefully.  
✓ Press the <+> and <-> keys or the <+> and <Shower> keys on the lateral control panel simultaneously.

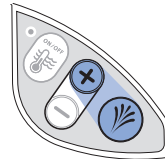
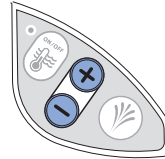

The spray arm returns to its starting position.

**7** Clean the spray arm opening.

- 
- 8** Press the <+> and <-> keys or the <+> and <Shower> keys on the lateral control panel simultaneously.

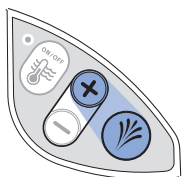
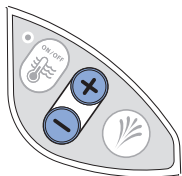

- ✓ The spray arm extends without spraying any water.

- 
- 9** Mount the spray nozzle.

- 10** Press the <+> and <-> keys or the <+> and <Shower> keys on the lateral control panel simultaneously.

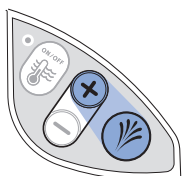
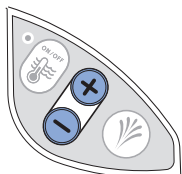

- ✓ The spray arm retracts fully. The cleaning procedure is now complete.

## Clean or replace the basket filter

- 1** Close the angle stop valve.

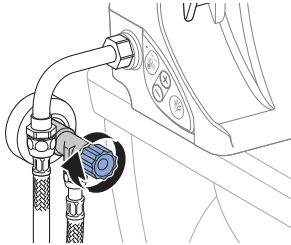

- 2** Loosen the connection bend and empty the residual water into a receptacle.

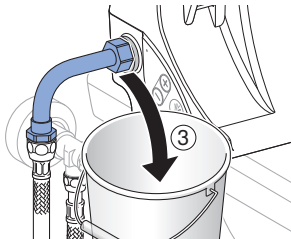
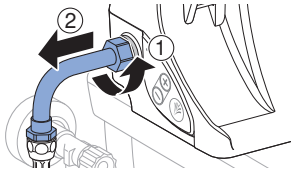

- 3** Remove the basket filter.

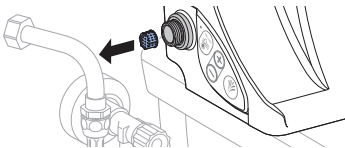

- 4** Clean and descale the basket filter.

- 5** Insert the basket filter.

- 6** Screw on the connection bend.

- 7** Open the angle stop valve.

## Replacing the compensation pads

**i** The shower toilet can be damaged if the compensation pads do not lie evenly on the WC ceramic appliance.

- 1** Lift up the WC lid and the WC seat ring.
- 2** Remove the damaged compensation pads.

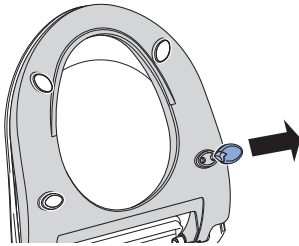

- 3** Insert suitable compensation pads.

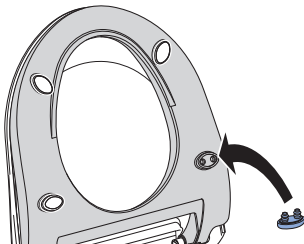

### Result

- ✓ The compensation pads are lying evenly on the ceramic pan.

## Empty the storage water heater

**i** If you are not going to use the Geberit AquaClean 4000 for a long period of time (e.g. whilst on holiday), we recommend that you empty the storage water heater.

**i** As soon as you recommission the Geberit AquaClean 4000, the storage water heater fills with water automatically.

### Prerequisite

- The angle stop valve is closed.
- The mains plug is disconnected.

- 1** Open the drain screw by turning it a quarter of a turn with a short screw-driver.

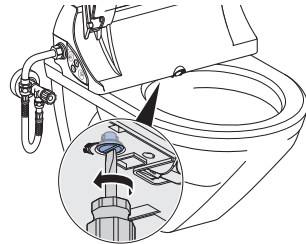

- ✓ The water from the storage water heater drains into the ceramic pan.

- 2** Close the drain screw.

# Troubleshooting

---

## The shower toilet is without function

The following table will help you with troubleshooting if the shower toilet is without function.

---



### **DANGER**

#### **Electric shock**

Incorrect maintenance work or troubleshooting can lead to serious injury or death.

- ▶ In case of malfunctions, the device must immediately be switched off at the power switch and the customer service must be contacted.
  - ▶ Only trained electrically skilled persons are permitted to perform electrical installations on the device.
  - ▶ Only trained professionals are permitted to perform retrofitting on the device.
- 



The shower toilet can be used as a normal toilet even in the event of a malfunction. The spray arm must be fully retracted. You start the toilet flush as usual by pressing the actuator buttons.



Description of problem	Cause	Fault clearance
<p>The fuse or residual-current device in the electrical distributor trips once.</p>	<p>Malfunction has occurred</p>	<ul style="list-style-type: none"> <li>▶ Replace or reset the fuse in the electrical distributor.</li> <li>▶ Reset the residual-current device in the electrical distributor.</li> </ul> <hr/> <p><b>Result</b></p> <ul style="list-style-type: none"> <li>✓ The device initialises again after switching on. Using the device does not trip any fuses or residual-current devices.</li> </ul>
<p>The fuse or residual-current device in the electrical distributor trips repeatedly when the device is used.</p>	<p>Device defective</p>	<ul style="list-style-type: none"> <li>▶ Replace or reset the fuse or residual-current device in the electrical distributor.</li> <li>▶ Disconnect the mains plug (if available).</li> <li>▶ contact customer service.</li> </ul>
<p>The product has an unknown technical defect.</p>	<p>Malfunction has occurred</p>	<ul style="list-style-type: none"> <li>▶ Trip the fuse or residual-current device in the electrical distributor.</li> <li>▶ Disconnect the mains plug (if available).</li> <li>▶ contact customer service.</li> <li>▶ Have the power supply tested by a skilled person.</li> </ul>

## Other functional errors

The following table will help you with troubleshooting if individual functions of the shower toilet have failed.

**i** The shower toilet can be used as a normal toilet even in the event of a malfunction. The spray arm must be fully retracted. You start the toilet flush as usual by pressing the buttons on the cistern.

**i** If the device is defective, switch it off using the power switch.

Description of problem	Cause	Fault clearance
Shower water temperature is too low.	Heating element is not switched on	▶ Set the storage water heater function on the lateral control panel to ON. → See "Switching the storage water heater function on and off", page 12
	Warm-up time too short when heating element is in economy mode	▶ Set the storage water heater function on the lateral control panel to ON. → See "Switching the storage water heater function on and off", page 12
Shower spray is too weak or no water is spraying out at all.	Spray intensity setting is too low	▶ Increase the spray intensity. → See "Set the spray intensity", page 13
	Spray nozzle is clogged or blocked with limescale	▶ Clean or replace the spray nozzle. → See "Clean the spray nozzle", page 20
	Basket filter is clogged or blocked with limescale	▶ Clean or replace the basket filter. → See "Clean or replace the basket filter", page 22
Spray arm does not retract.	Power supply interrupted	▶ Restore the power supply. The spray arm retracts automatically.
	WC enhancement solution defective	▶ Disconnect the mains plug and contact customer service.
The soft-closing mechanism is not working.	Hydraulics defective	▶ Contact customer service.
Water runs out of the safety overflow on the left next to the spray arm.	Solenoid valve defective	▶ Disconnect the mains plug, close the angle stop valve, and contact customer service.
	Level probe defective	
	Control defective	
WC seat rocks.	Compensation pad missing	▶ Mount new compensation pads. → See "Replacing the compensation pads", page 23
	'Standard' compensation pads are mounted	▶ Replace 'standard' compensation pads with 'raised' compensation pads. → See "Replacing the compensation pads", page 23

Description of problem	Cause	Fault clearance
LED flashes red: once every 2seconds.	Temperature sensor defective	▶ Contact customer service.
LED flashes red: twice every 2seconds.	Angle stop valve closed	▶ Open the angle stop valve. → See "Clean or replace the basket filter", page 22
	Basket filter is clogged or blocked with limescale	▶ Clean or replace the basket filter ▶ → See "Clean or replace the basket filter", page 22
LED flashes red: three times every 2seconds.	Shower arm blocked	▶ Check the opening of the spray arm. ▶ Check the spray nozzle position, push the nozzle on correctly. ▶ Contact customer service.
LED flashes red: four times every 2seconds.	Water is warmer than 45°C. Thermal cut-out has tripped.	▶ Contact customer service.
LED flashes red: five times every 2seconds.	Water pump no longer working properly or defective.	▶ Contact customer service.

2 / 2

# Sustainability

---

## Geberit Group and sustainability

As the European market leader in the sanitary industry, Geberit stands for water saving, resource efficiency and sustainable building. The Group has proven for decades that long-term business success is compatible with environmentally friendly actions and social policies. A company management geared to sustainability helps to save costs while minimizing risks at the same time. Geberit aims to act as a role model and set standards for its customers, suppliers and other partners. This means creating water-saving and sustainable products, using safe, environmentally friendly and resource-efficient production practices, engaging in purchasing and logistics activities with high environmental and ethical standards, and offering excellent working conditions for more than 12 000 dedicated and highly qualified employees worldwide. One way in which the company is showing its awareness of social responsibility is by participating in water relief projects around the world.

## Ecodesign – ecobalance

The basis for sustainable products is formed by a systematic innovation process in which product materials and functional principles are chosen that are as environmentally friendly as possible, risks are minimised and a high degree of resource efficiency is strived for. We can supply a detailed ecobalance for this product upon request.

## Tips for reducing the ecological footprint

This product was developed with the utmost care, also with regard to the consumption of energy, water and resources (see also technical data). You can reduce the ecological footprint of the product by observing the following recommendations:

- Switch off the device when you go on holiday.
- Interrupt the spray functionality manually in order to save hot water.
- Use small amounts of paper for drying.
- Switch off the heating function of the water heater when you do not need warm shower water.
- Use environmentally friendly cleaning agents.
- Carry out regular maintenance on the device and handle it with care in order to extend the service life.
- Return defective devices to Geberit or a designated partner for appropriate disposal.

# Disposal

---

## Disposal of waste electrical and electronic equipment



The symbol of the crossed-out wheeled bin means that waste electrical and electronic equipment (WEEE) must be disposed of separately and not with other non-recyclable waste. End users are legally obliged to return old equipment to public waste disposal authorities, distributors, or Geberit for proper disposal. Many distributors of electrical and electronic equipment are obliged to take back WEEE free of charge. Contact the responsible sales or service company to return the WEEE to Geberit.

Used batteries and accumulators that are not enclosed within the old equipment, as well as lamps that can be removed from the old equipment in a non-destructive manner, must be separated from the old equipment before being handed over to a disposal point.

If personal data is stored on the old equipment, end users themselves are responsible for deleting it before handing it over to a disposal point.

# End user warranty

---

## End user warranty

The following end user warranty is provided in addition to and does not affect your contractual partner's liability for defective products.

The Geberit company ("Geberit") responsible for the place of installation of the Geberit AquaClean product ("product") shall provide the end user with a warranty for the product identified by the serial number on the warranty card. The scope of this warranty is as follows:

1. Geberit guarantees that the product shall be free from material defects and manufacturing faults for a period of 3 years ("warranty period") calculated from the installation date at the end user's premises. Warranty scope:
  - Within the first 2 years of the warranty period, a customer service representative authorised by Geberit shall rectify any material defects or manufacturing faults free of charge by repairing or replacing the defective parts.
  - In the third year of the warranty period, Geberit shall supply replacements for defective parts free of charge to the customer service representative authorised by Geberit and contracted by the end user to repair the product.
2. The end user shall not be entitled to assert more extensive claims against Geberit on the basis of this warranty.
3. Claims can only be made under the warranty if:
  - The product has been installed and put into operation by an installation company or by customer service personnel authorised by Geberit.
  - No modifications have been made to the product; in particular, no parts have been removed, replaced or added.
  - The product defect has not been caused by improper installation or use, nor can it be attributed to inadequate care or maintenance.
  - Claims shall only be made during the third year of the warranty period if the end user has completed the enclosed warranty card in full and returned it to the Geberit company responsible for the place of installation within 90 working days of the installation date.
4. This warranty applies solely to places of installation in countries in which Geberit has its own sales company or is represented by a sales partner.
5. The warranty is exclusively subject to the substantive law of the country in which Geberit has its place of business. The United Nations Convention on Contracts for the International Sale of Goods is expressly excluded. The exclusive place of jurisdiction for all disputes arising from or in connection with this warranty is the location of Geberit's headquarters.

# Technical data and conformity

## Technical data

Nominal voltage	230 V AC
Mains frequency	50–60 Hz
Power consumption	800 W
Power consumption economy mode/with heating switched on	0.45/5.8 W
Protection degree	IPX4
Protection class	I
Cable length	2 m
Wireless technology	Radar sensor
Frequency range	10.525 GHz
Maximum output power	-9.5 dBm
Number of shower pressure settings, shower spray	5
Water temperature, factory setting	37 °C
Operating temperature	10–40 °C
Flow pressure	50–1000 kPa
	0.5–10 bar
Minimum flow pressure	50 kPa
	0.5 bar
Storage water heater capacity	0.9 l
Flow rate, anal shower	0.9–1.5 l/min
Water temperature, factory setting	37 °C
Spray time	20 s
Calculated flow rate	0.04 l/s
Maximum load, WC seat	150 kg

## Simplified EU Declaration of Conformity

Geberit International AG hereby declares that the radio equipment type Geberit AquaClean 4000 complies with Directive 2014/53/EU.

The full text of the EU declaration of conformity is available at the following Internet address: <https://doc.geberit.com/969885000.pdf>.

## Simplified UK Declaration of Conformity

Hereby, Geberit International AG declares that the radio equipment type Geberit AquaClean 4000 is in compliance with the Radio Equipment Regulations 2017.

The full text of the UK declaration of conformity is available at the following Internet address: <https://doc.geberit.com/970864000.pdf>

**(CH) Geberit Vertriebs AG**  
Schachenstrasse 77  
CH-8645 Jona  
T 0848 882 982  
www.geberit-aquaclean.ch

**(DE) Geberit Vertriebs GmbH**  
Kundendienst/Serviceestelle  
Theuerbachstrasse 1  
D-88630 Pfullendorf  
T (075 52) 934 10 11  
F (075 52) 934 866  
www.geberit-aquaclean.de

**(AT) Geberit Vertriebs GmbH & Co. KG**  
Geberitstrasse 1  
A-3140 Pottenbrunn / St. Pölten  
T +43 2742 401-500  
www.geberit-aquaclean.at

**(AE) Geberit International Sales AG**  
Dubai Branch  
B702-B705  
Building No. 1  
Dubai Design District  
PO Box  
UAE-282317 Dubai  
T +971 4 204 5477  
F +971 4 204 5497  
www.geberit.ae

**(BE) Geberit nv**  
Ossegemstraat 24  
B-1860 Meise  
T +32 2 252 0111  
F +32 2 251 0867  
www.geberit-aquaclean.be

**(BG) Юнитрейд Интернешънъл ЕООД**  
бул. "Черни връх" 161-А  
1407 София  
T 02/ 968 11 11  
F 02/ 968 10 01  
www.unitrade-bg.com

**(CN) 吉博力(上海)贸易有限公司**  
地址: 上海市嘉定区南翔高科技  
园区惠平路1515号  
邮编: 201802

**(CZ) Geberit spol. s r.o.**  
Sokolovská 2408/222  
190 00 Praha 9  
T +420 547 212 335  
F +420 547 212 340  
www.geberit.cz

**(DK) Geberit A/S**  
Lægårdsvej 26  
DK-8520 Lystrup  
T +45 86 74 10 86  
F +45 86 74 10 98  
www.geberit-aquaclean.dk

**(ES) Geberit, S.A.U.**  
Plaza Europa, 2-4, 6ª planta  
ES-08902 L'Hospitalet del Llobregat  
(Barcelona)  
T +34 902 170 635  
www.geberit-aquaclean.es

**(FI) Geberit Oy**  
Tahkotie 1  
FI-01530 Vantaa  
P +358 9 867 8450  
www.geberit.fi

**(FR) Geberit France**  
ZA du Bois Gasseau - CS40252  
Samoreau  
FR-77215 Avon Cedex  
Téléphone 01 60 71 66 61  
T +33(0)825 801 603  
F +33(0)825 801 604  
www.geberit-aquaclean.fr

**(GB) Geberit Sales Ltd.**  
Geberit House  
Edgehill Drive  
Warwick  
CV34 6NH  
T (0)1926 516 800  
T (0)1926 516 809  
In Eire T +44 1622 717 811  
www.geberit-aquaclean.co.uk

**(HR) Predstavništvo Geberit**  
prodaja d.o.o. Ruše  
Samoborska cesta 218  
10090 Zagreb, HR  
T +385 1 3867 800  
F +385 1 3867 801  
www.geberit.hr

**(HU) Geberit Kft**  
1117 Budapest,  
Aliz utca 2.  
T +36 1 204 4187  
www.geberit.hu

**(IT) Geberit Marketing e Distribuzione SA**  
Via Gerre 4  
CH-6928 Manno  
T +41 91 611 92 92  
F +41 91 611 93 93  
www.geberit-aquaclean.it

**(LU) Geberit Luxembourg**  
61, avenue de la Libération  
L-3850 Schifflange  
T +352 54 52 26  
F +352 54 54 91  
www.geberit.lu

**(NL) Geberit B.V.**  
Fultonbaan 15  
3439 NE Nieuwegein  
T +31 (0)3060 57700  
F +31 (0)3060 53392  
www.geberit-aquaclean.nl

**(NO) Geberit AS**  
Luhrtoppen 2  
N-1470 Lørenskog  
T +47 67 97 82 00  
www.geberit-aquaclean.no

**(PL) Geberit Sp. z o.o.**  
ul. Postępu 1  
02-676 Warszawa  
T +48 22 843 06 96  
www.geberit-aquaclean.pl

**(PT) Geberit Tecnologia Sanitária, S.A**  
Rua Cupertino de Miranda, nº 12-2º A  
PT-1600-485 LISBOA  
www.geberit.pt

**(RO) Geberit International Sales AG**  
Splaiul Unirii, Nr. 86, Et. 3  
Sector 4, Bucharest  
T +40 21 330 30 80/81  
F +40 21 330 31 61  
www.geberit.ro

**(RS) Geberit - Predstavništvo za**  
Republiku Srbiju i Republiku Crnu Goru  
Vojvode Skopljanca 24  
SR-11000 Beograd  
T +381 11 30 96 430  
F +381 11 30 96 431  
www.geberit.rs

**(RU) ООО „ГЕБЕРИТ РУС“**  
Олимпийский пр., 16, стр.5, 5 этаж  
129110 Москва  
тел.: +7 495 783 83 30  
www.geberit.ru

**(SE) Geberit AB**  
Folketshusgatan 1  
Box 140  
295 22 Bromölla  
T +46 40 680 89 30  
www.geberit.se

**(SI) Geberit prodaja, d.o.o.**  
Bezena 55  
2342 Ruše  
T 01 586 22 00  
F 01 586 22 19  
www.geberit.si

**(SK) Geberit Slovensko s.r.o**  
Karadžičova 10  
821 08 Bratislava 2  
T +421 2 49 20 30 71  
www.geberit.sk

**(TR) Geberit Tesisat Sistemleri Tic Ltd. ti.**  
Içerenköy Mah. Engin Sok. No. 10,  
34752 Atasehir-Ystanbul, Turkey  
T +90 216 340 82 73  
F +90 216 340 82 79  
www.geberit.com.tr

**(ZA) Geberit Southern Africa (Pty.) Ltd.**  
6 Meadowview Lane,  
Meadowview Business Estate,  
Longmeadow,  
Linbro Park  
Johannesburg,  
South Africa  
T +27 11 444 5070  
F +27 11 444 5992  
www.geberit.co.za

