

Product Overview: The AKW emergency audio alarm operates by a simple pull cord to allow users to raise an alarm from within a toilet or closed room.

- Features:**
- Easy to operate control panel with 2 LEDs: green for 'on', red for activated
 - Reset Switch
 - In standby mode the alarm shows a green 'power on' light. Once pulled, a flashing red 'alarm' light is triggered, along with an audio signal.
 - Long pull cord with two red bangles for ease of grip



- Benefits:**
- Provides peace of mind for users in a domestic or commercial application
 - Easy to install
 - Designed to adhere to Doc M building regulations

Certification:



Product Specification:

- 12V DC Power supply
- 90dbA
- Can be connected to a 3A fused switched spur or plugged into a dedicated 3A fused, 230V AC supply socket
- Designed to BS8300:2009 guidelines

Dimensions:

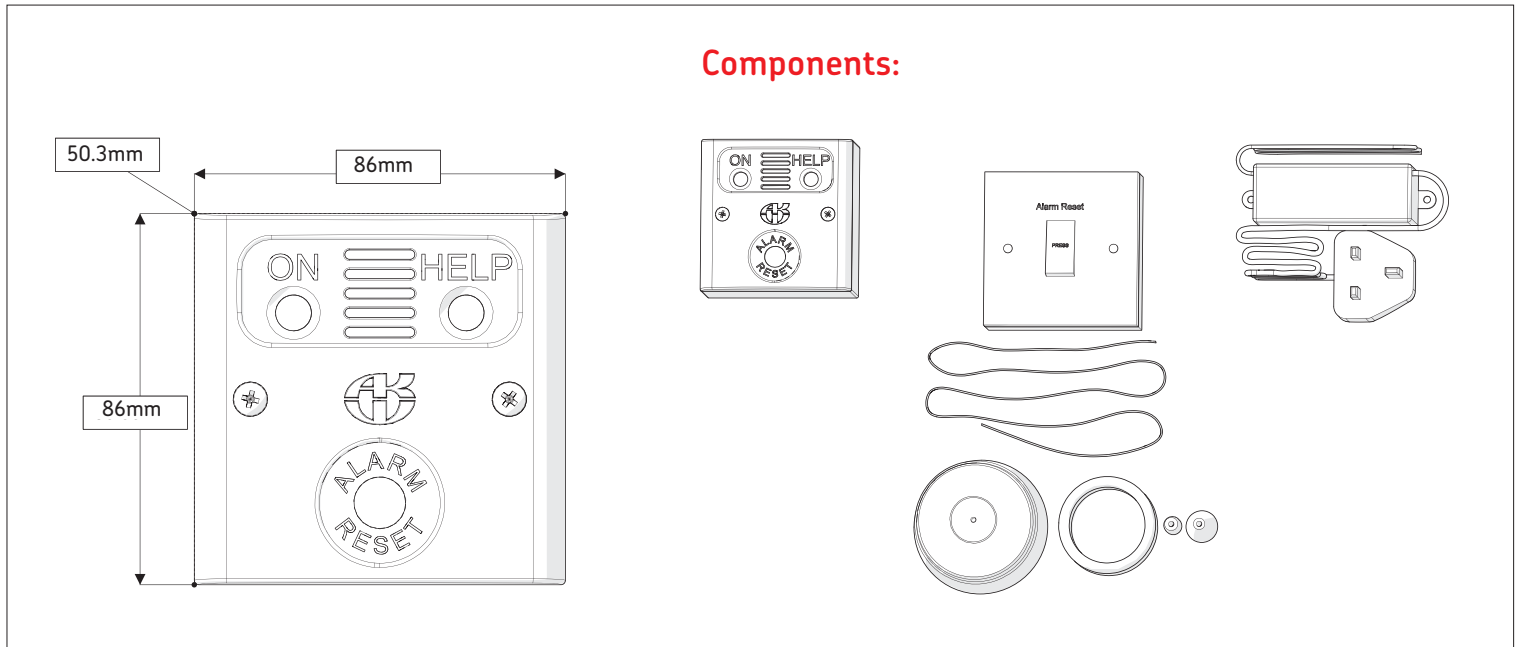

Product Codes:

| Codes | Description |
|-------|-----------------------------|
| 23143 | Emergency Alarm & Pull Cord |