

Assembly guide

Soft close 1000 RH
Pull & Swing Corner Unit

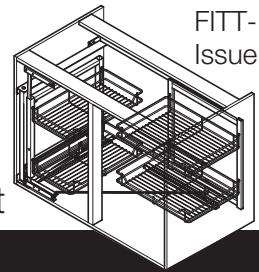

Component parts

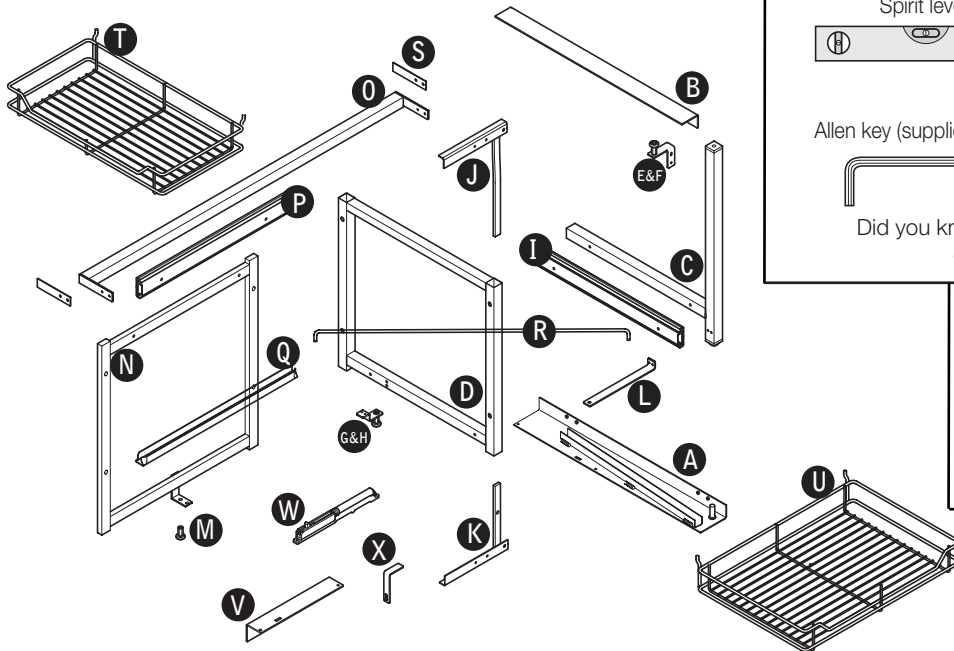

Tools required (Not Supplied)

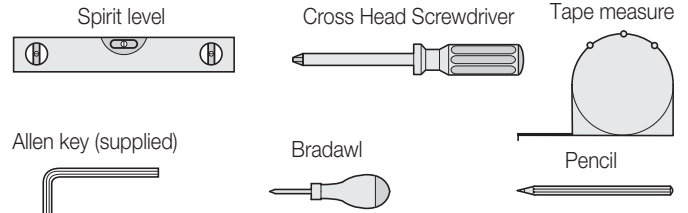

Did you know Häfele also supply tools to the trade and industry?
See www.hafele.co.uk for more information.

- Make sure all the components are included before you start.
- The number for technical support is at the bottom of the page.
- Don't rush!
- Read the instructions first.
- Assemble in the stages shown.
- Keep the fittings together to avoid loss.
- Have fun.

Before you start... Check the pack and make sure all the components and fixings are included – see also fixings page 8, if not call the **Helpline on 01788 548800** and our team will get things sorted. When you are ready to start make sure you have the right tools to hand, plenty of space and a clean dry area for building. Don't rush, read the instructions first and run through the sequence before you begin. Assembly should be done in the stages shown in the following diagrams, keeping fittings together to avoid loss.

Cleaning - Use mild soap and water only. Do not use abrasive cleaners.

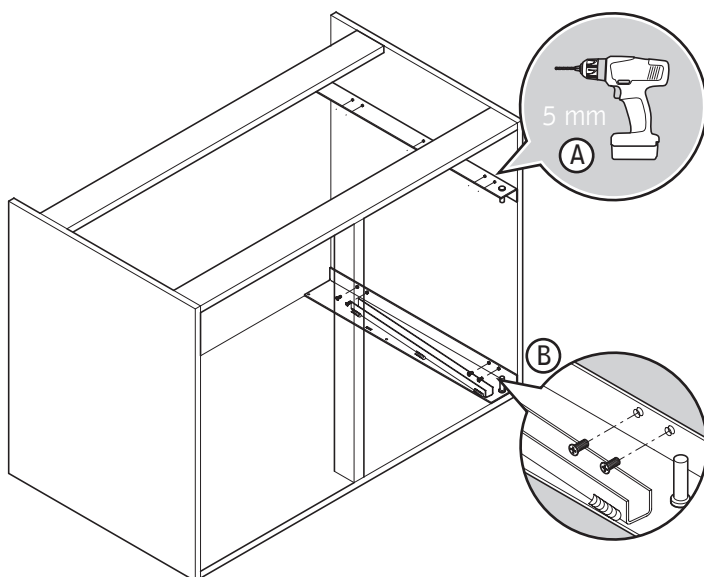

- 1 A.** Using a tape measure and pencil mark out 5 x 5 mm holes for the top plate (B) at a height of 510 mm, height from hole centre to cabinet base as shown above. Pre drill using a 5 mm drill bit. Do not fix the top plate at this point.
B. Locate base plate (A) inline with the front edge of the cabinet. Pre drill 4 x 5 mm holes and secure with 4 x Euro screws.

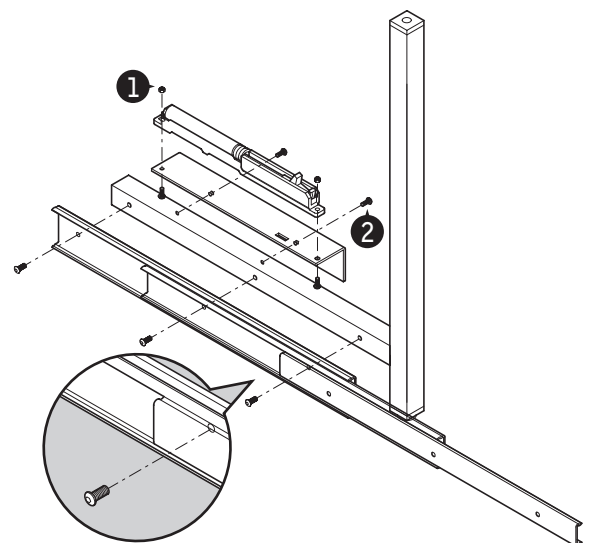

- 2 FRAME C ASSEMBLY**
Take frame (C) and runner (I) extend the runner to its full extension and secure the runner to frame (C) with 3 x M4 x 10 mm allen bolts as shown above. Attach damper (W) to bracket (V) with 2 x M4 x 10 mm allen bolts and 2 x nyloc nuts (fig. 1). Attach (W) and (V) to frame (C) with 2 x M4 allen bolts (fig. 2).

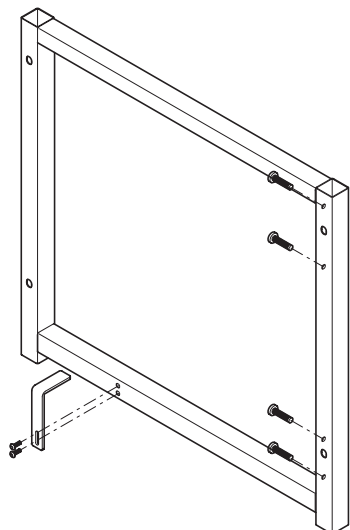

- 3 Insert 4 x M6 x 25 mm pozi screws loosely into frame (D) as shown above. Attach soft close trigger bracket (X) to frame (D) with 2 x M4 x 10 mm allen bolts.

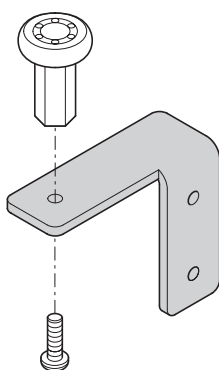

- 5 **Roller assembly**
Assemble roller bearing (F) to bracket (E) using 1 x M5 x 12 mm allen bolt.

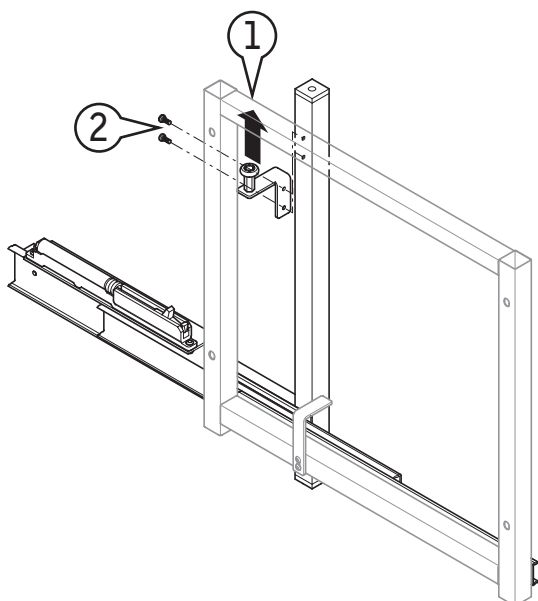

- 7 Position **Roller assembly** into the channel on frame (D) as in fig 1. above, then fix to frame (C) fig. 2 using 2 x M4 x 10 mm allen bolts.

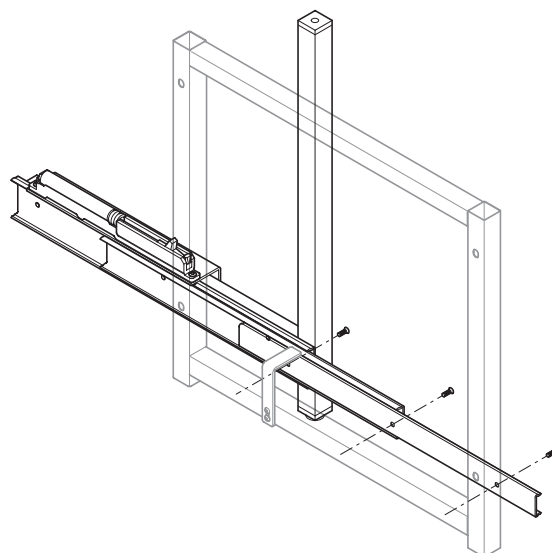

- 4 Layout frame (D) as shown above. Secure frame (D) to the slide on frame (C) using 3 x M4 x 10 mm allen bolts. Pull the soft close damper (W) forwards to set it, adjust the height of the trigger bracket (X) so that it engages with the soft close damper as the frame is extended and returned to the closed position.

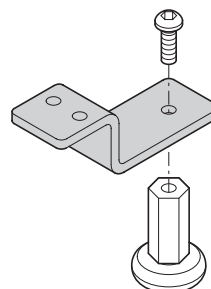

- 6 **Roller guide assembly**
Assemble roller bearing (G) to bracket (H) using 1 x M5 x 12 mm allen bolt.

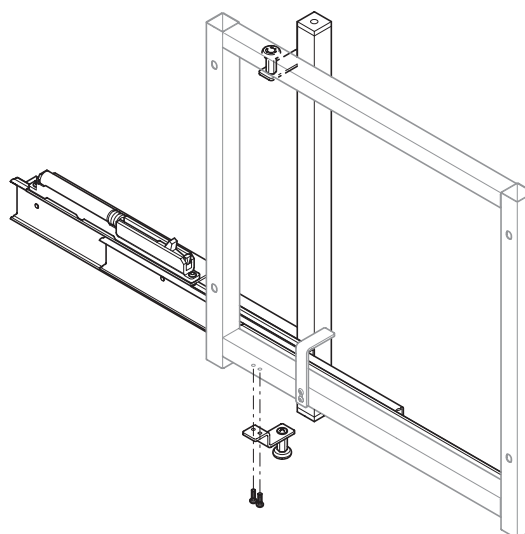

- 8 Fix roller guide assembly to the underside of frame (D) using 2 x M4 x 10 mm allen bolts.

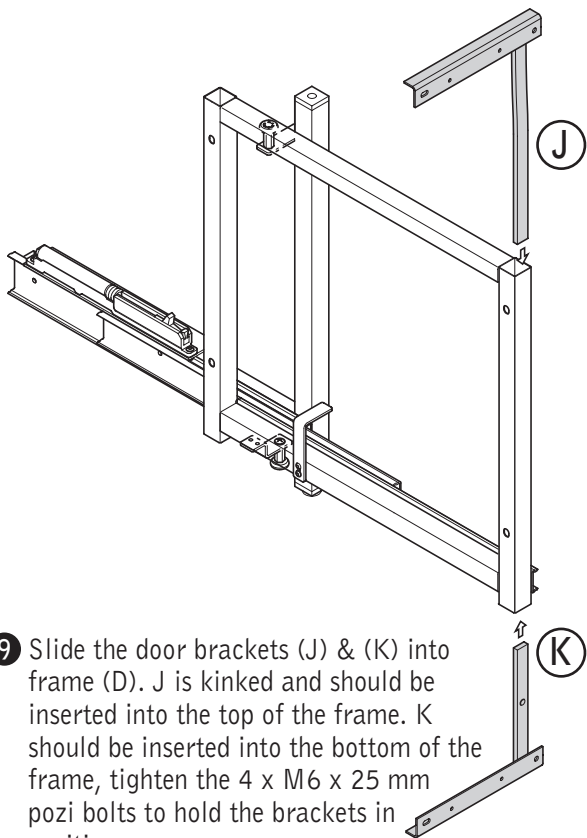

- 9 Slide the door brackets (J) & (K) into frame (D). J is kinked and should be inserted into the top of the frame. K should be inserted into the bottom of the frame, tighten the 4 x M6 x 25 mm pozi bolts to hold the brackets in position.

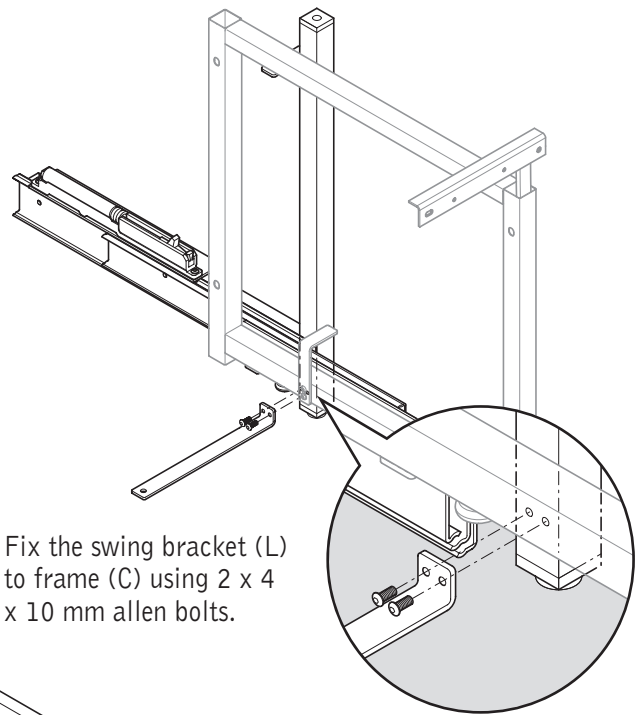

- 10 Fix the swing bracket (L) to frame (C) using 2 x 4 x 10 mm allen bolts.

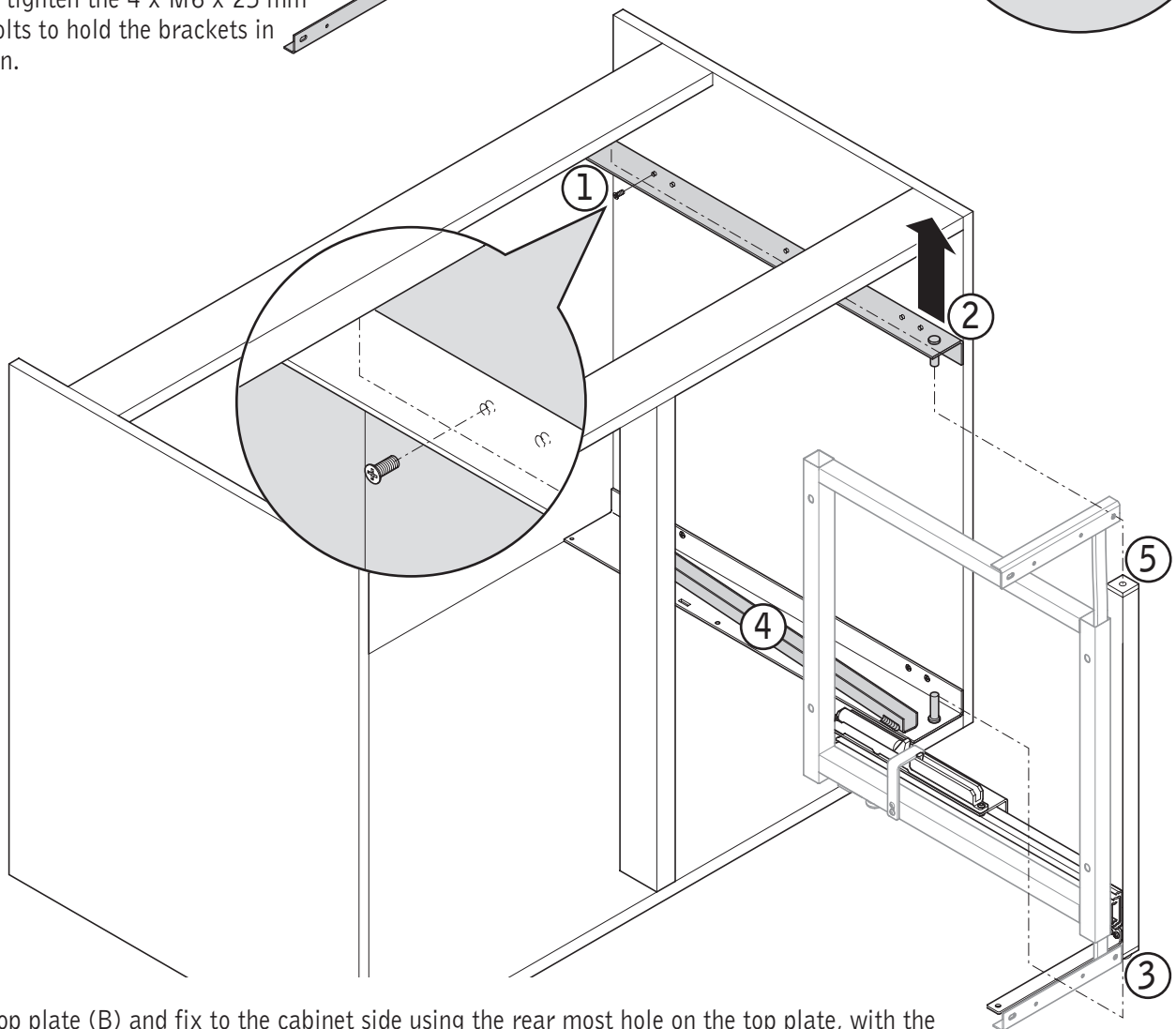

- 11 Take top plate (B) and fix to the cabinet side using the rear most hole on the top plate, with the corresponding pilot hole on the cabinet with 1 x Euroscrew **fig. 1**. Lift the front edge of top plate (B) **fig. 2** so that the assembled frame can be lowered into position, allowing the bottom end cap on frame (C) **fig. 3** to locate with the pin on base plate (A), ensuring that the roller guide assembly locates into the guide channel on base plate (A) **fig. 4**. Lower top plate (B) so that the pin locates into the hole on the top end cap of frame (C) **fig. 5**.

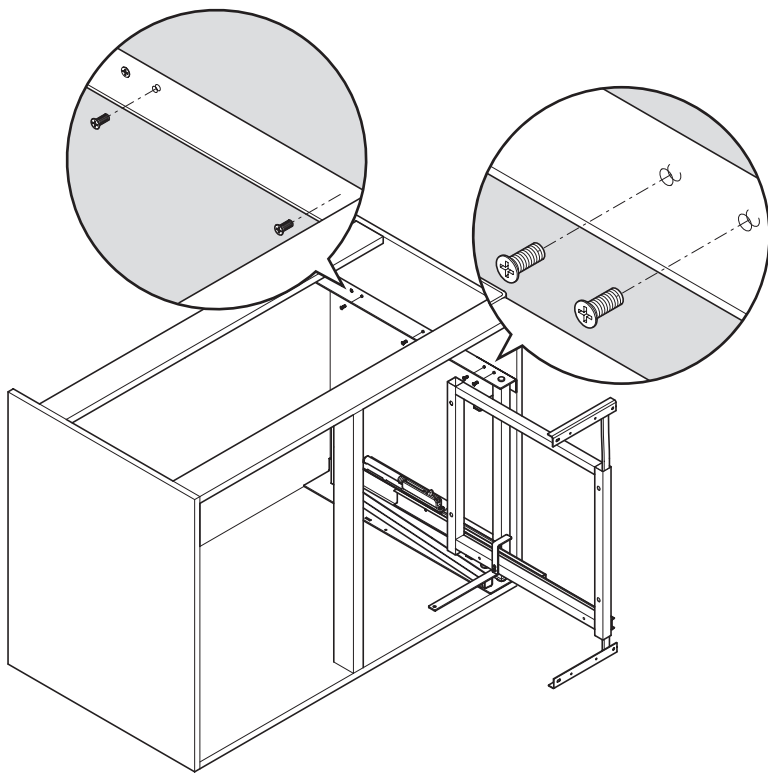

- 12 Secure top plate (B) into position using 4 x Euro screws in the remaining fixing holes and fully tighten all 5 screws.

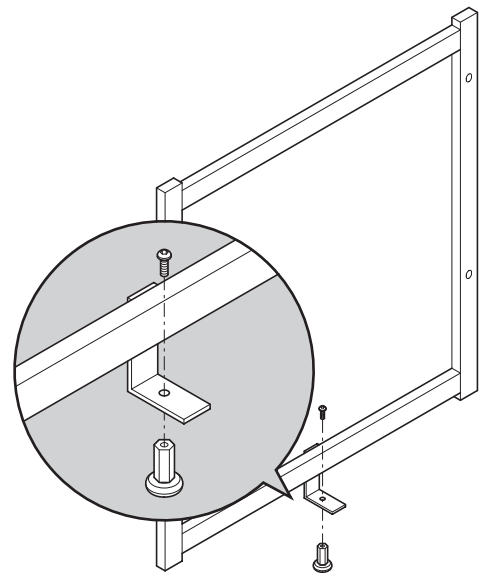

- 13 Fix the roller (M) to rear frame assembly (N) using 1 x M5 x 12 mm allen bolt.

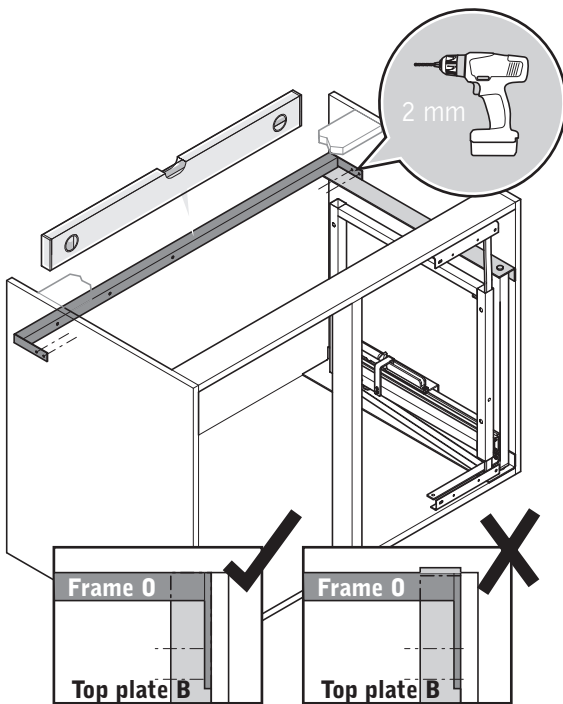

IMPORTANT PLEASE ENSURE:

The top rear frame must be level and parallel with the cabinet base.

The rear of the top rear frame (O) must be fixed so it is flush with the rear of top plate (B) for the fully assembled unit to function correctly. please ensure a spirit level is used for this task.

- 14 Position top rear frame (O) so that it lies flush with top plate (B) as shown above, pre drill 4 x 2 mm pilot holes. **(DO NOT INSTALL AT THIS POINT)**

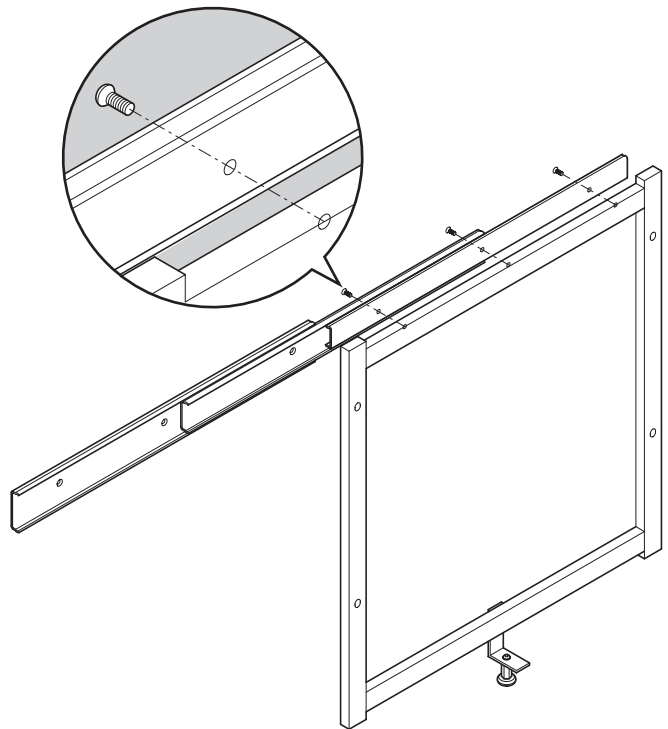

- 15 Fix the runner (P) to rear frame assembly (N) using 3 x M4 x 10 mm allen bolts.

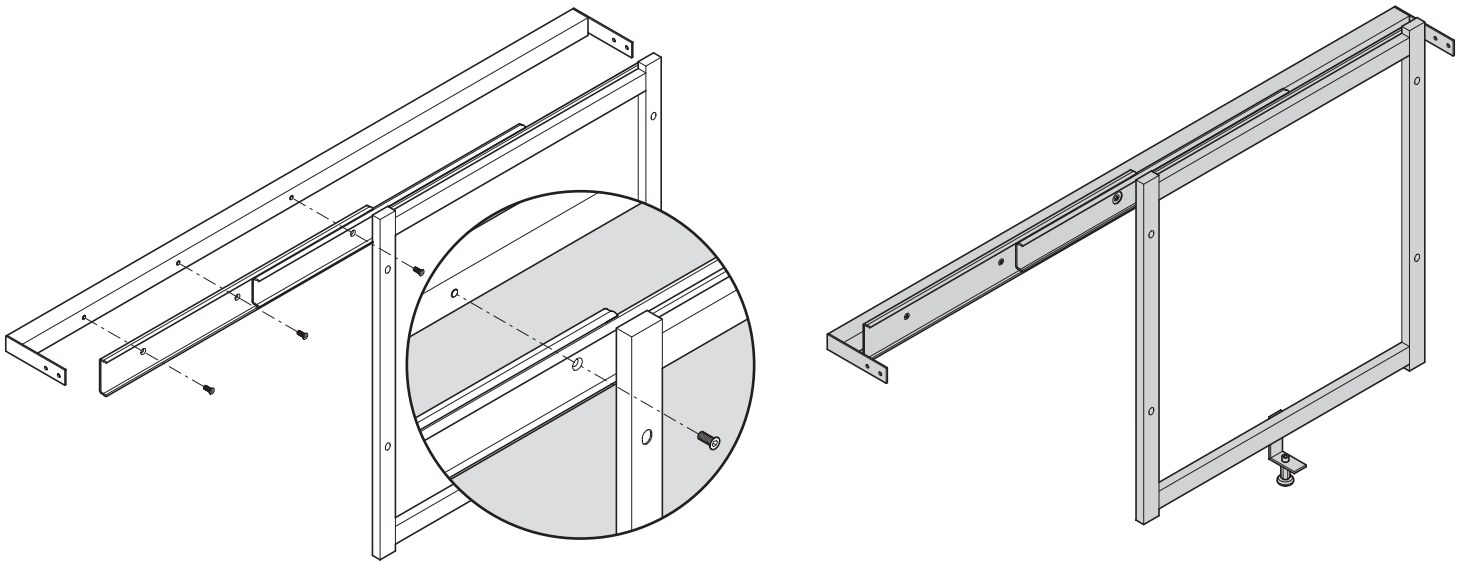

16 Rear frame assembly

Fix the rear frame (N) to the top rear frame (O) as shown above using 3 x M4 x 10 mm allen bolts.

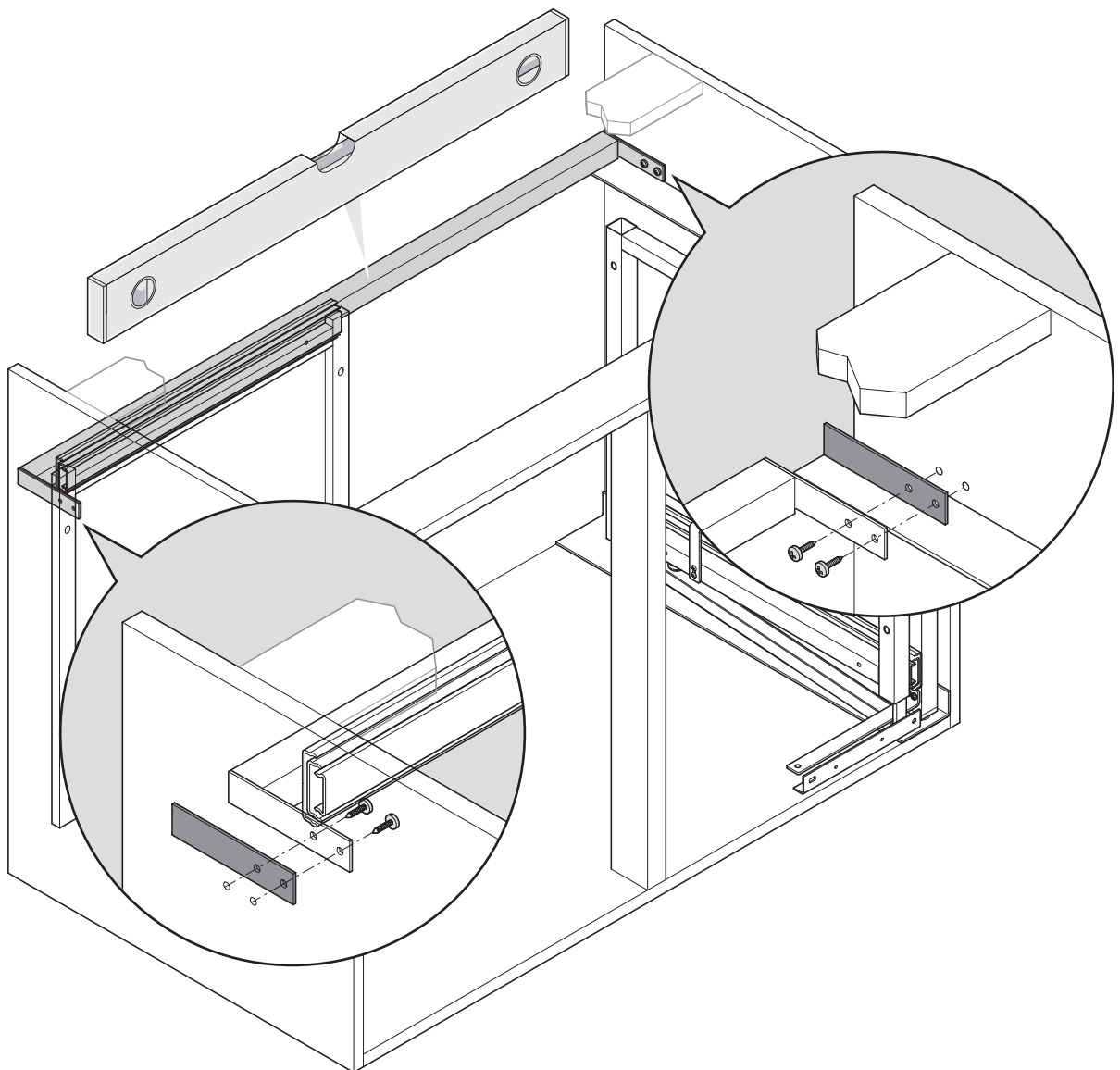

- 17 Take the assembled rear frame as shown above right and pass into the cabinet resting on the top plate (B) position the frame so it lies flush with the rear of top plate (B), then secure using 4 x 16 mm No.8 pozi pan head screws 2 at each end, into the pre-drilled pilot holes. if this unit is being fitted into a cabinet with 16 mm sides the spacers (S) can be used as shown above.

Check vertical then fix

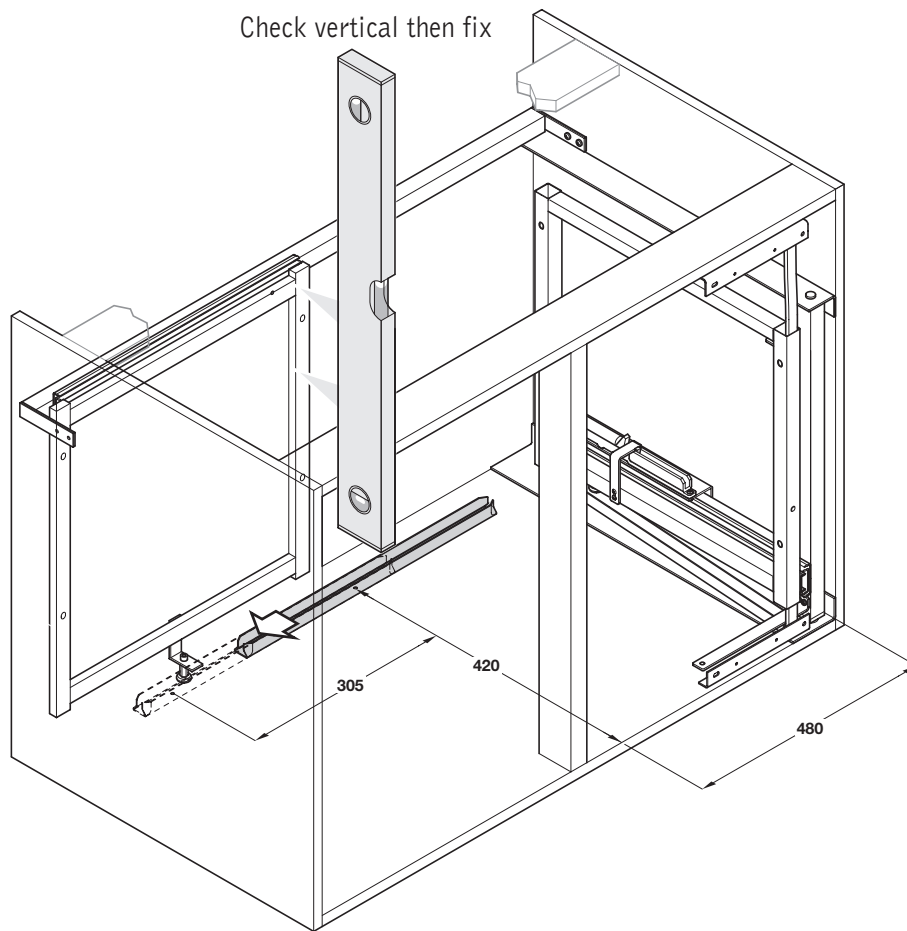

- 18 Fit the roller guide (Q) so that the rear frame sits vertically use the dimensions above. Secure using 2 x 16mm, No.8 pozi countersunk screws.

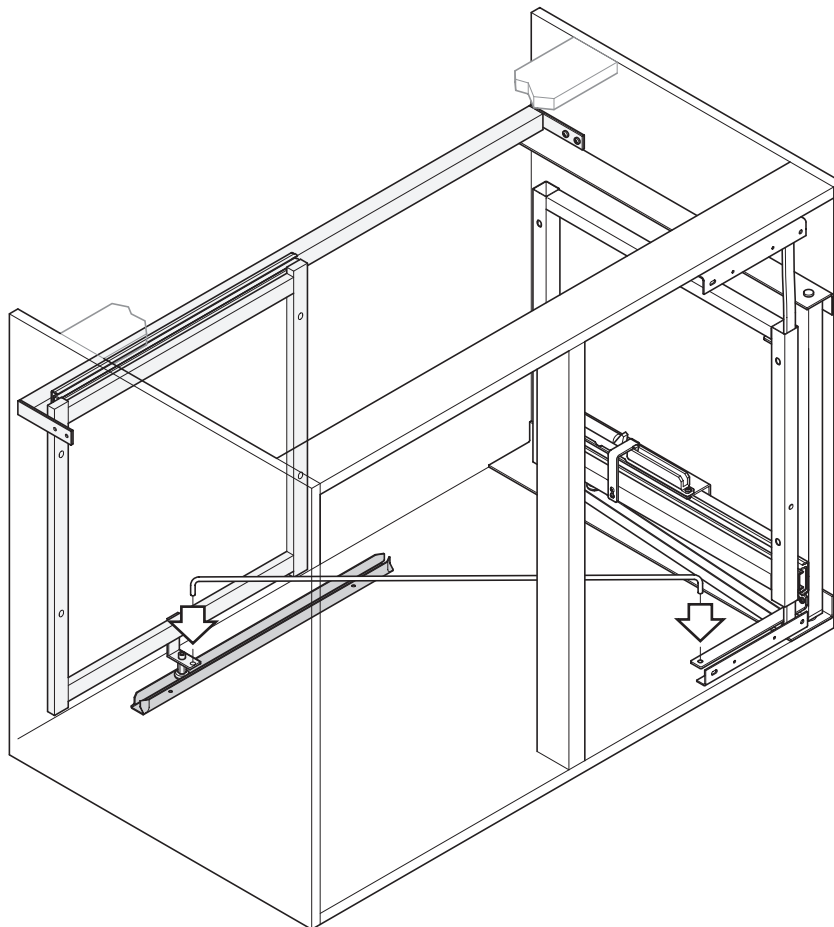

- 19 Locate connecting rod (R) into holes on (L) and rear frame (N). Check that when the frame is pulled outside the cabinet that the rear frame slides to an accessible position. If this is not the case then check you have followed the previous assembly steps and dimensions correctly.

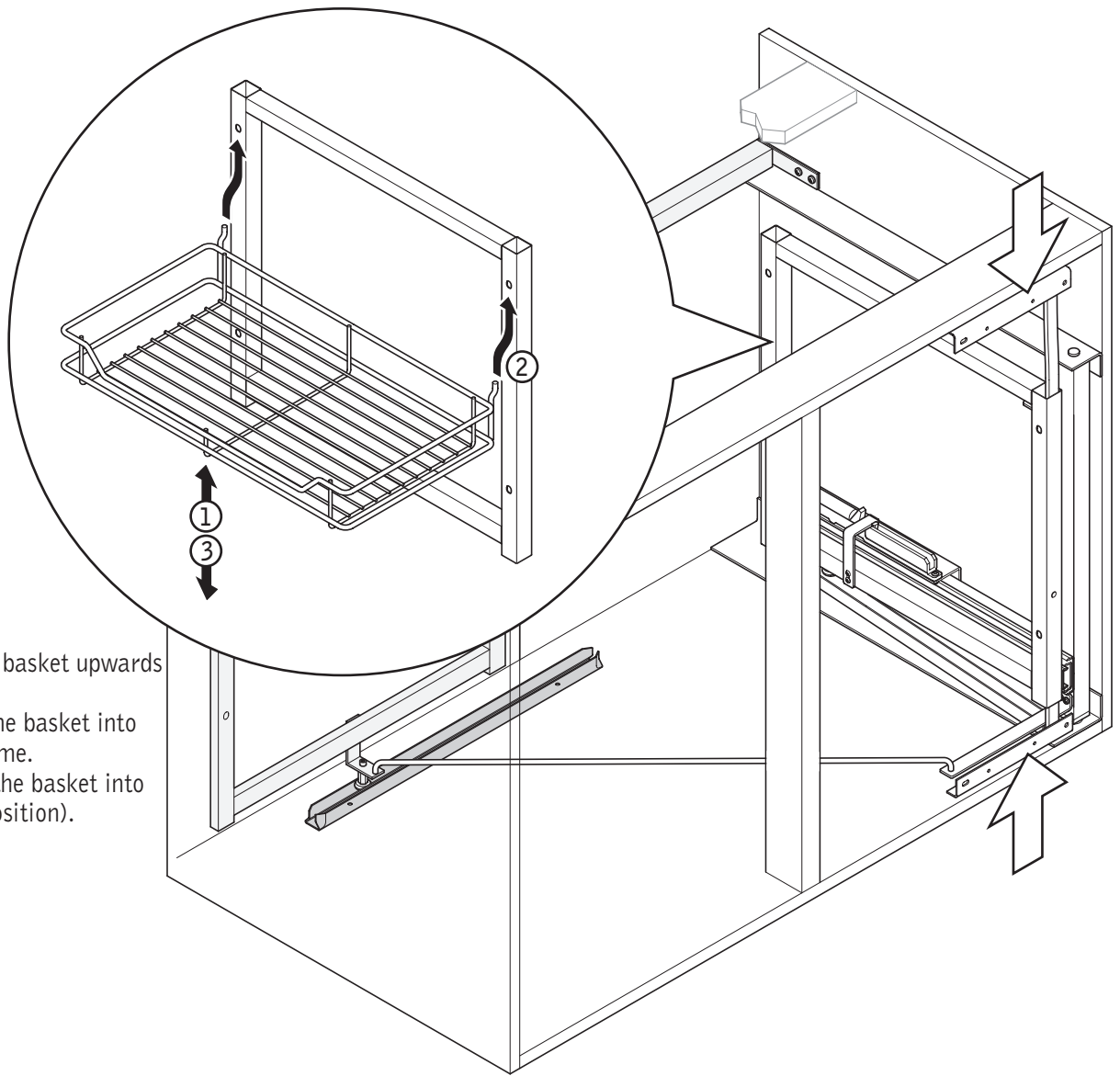

FITTING BASKETS

1. Tilt the front of the basket upwards by 45°.
2. Insert the pins on the basket into the holes on the frame.
3. Lower the front of the basket into place (horizontal position).

- 20 Adjust the door brackets to the desired height. Note - the lower bracket has limited height adjustment. It should be fixed in a position so that it does not clash with (L) or the cabinet edge. Once both door brackets have been set at an appropriate heights firmly secure in place by tightening the 4 x M6 x 25 mm pozi screws.

Take measurements and transfer them to the back of the cabinet door. Pre-drill 5 mm pilot hole to a depth of 13 mm being careful not to damage the front face of the door.

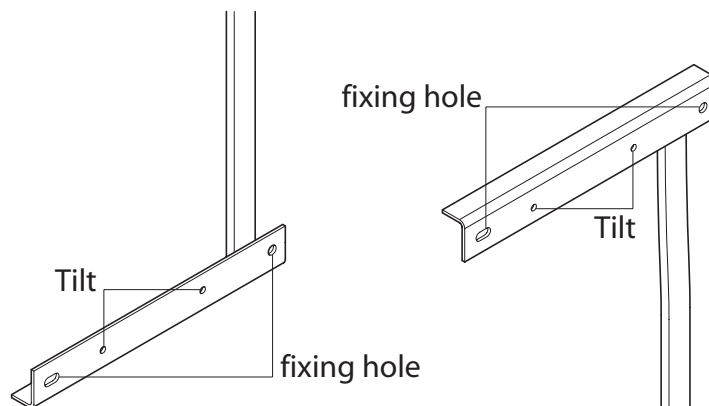

21 Fix the door

to the door brackets using 4 x euro screws and adjust the door using 4 x M5 x 10 mm screw. Further adjustment can be made by loosening the 4 x 25 x 10 mm pozi screws and repositioning the door before re-tightening although care must be taken that the lower door bracket does not foul the cabinet side or the swing bracket. For tilt adjustment loosen the euro screws slightly and then screw 4 x M5 x 10 mm screws into the bracket to achieve the desired tilt alignment.

DRILLING DIMENSIONS

Ensure all dimensions are checked and that all holes are marked with a pencil and that a pilot hole is drilled before fixing any part/s to the cabinet.

FIXINGS

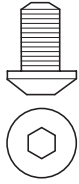

- 24 x M4 x 10 mm Allen bolt.



- 13 x Euro screw.



- 4 x M6 x 25 mm Pozi pan head machine screw.



- 3 x M5 x 12 mm Allen bolt.



- 4 x 16 mm, No. 8 Pozi pan head wood screw.



- 2 x 16 mm, No. 8 Pozi Countersunk wood screw.



- 4 x M5 x 10mm Pozi pan head machine screw.



- 2 x M4 Nyloc nut.

- 3 x Roller bearings.

- 2 x Spacers.

- 1 x End cap (grey plastic).

