

Linear Deck Installation Instructions

Please ensure all tradesmen working on or around the installation have consulted these instructions and understand how to maintain the waterproofing integrity.

Maxxus Guarantee

If installed correctly by a competent person and used for normal wetroom applications the Maxxus (*and membrane if supplied by us as a kit*) have a life-of-tiling guarantee (*if grout lines are maintained*). No guarantee is offered where this is not the case.

Installation Overview

These instructions assume the wetroom has been appropriately designed and all plumbing and electrical work is to building regulations. These instructions will cover the most typical level floor installations on suspended timber or solid concrete floors. For raised floors areas the instructions can be applied where appropriate.

The Maxxus is a load bearing deck which can sustain a load of 470kgs over 400mm joist centres without deflection and as such requires no under boarding.

Installation on Timber Floors

If setting the deck into an existing timber floor first remove the floorboards to expose the joists in the area where the deck will be fitted.

Inspect the integrity of the existing joists and if in doubt remedial action should be taken to ensure the floor is strong and stable.

The Maxxus deck can be laid straight over the existing joists without under-boarding, however if the joist centres are over 400mm installing additional noggins for support may be required.

Fix two timber noggins either side of the channel drain for extra support.

All edges of the deck must also be supported with noggins.

The waste connection must now be considered.

Lay the deck into position and connect the waste.

Pilot drill the deck and screw down to the joists using woodscrews ensuring a secure fixing, once the deck has been fixed check to make sure there is no movement and the deck is level.

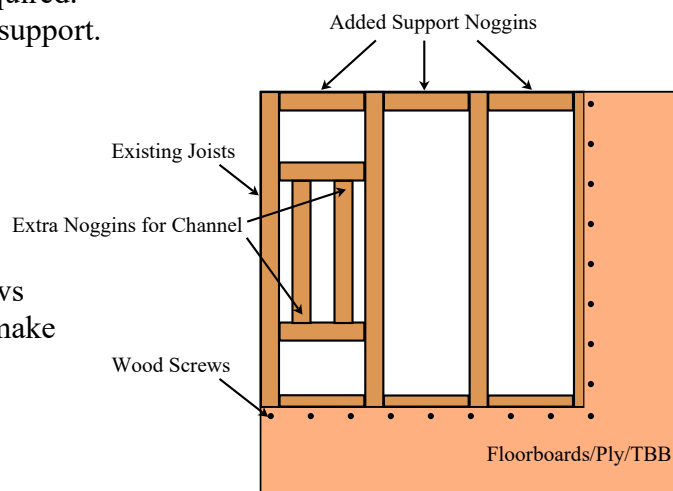

Installation on Concrete Floors

Installing inset into concrete

The area beneath the deck must be cut and chiseled out to accommodate the deck, drain and waste pipe.

For final fitting fully bed the deck down on tile adhesive ensuring the deck is level then allow to fully dry.

Pilot and screw the deck down.

Ensure there is no movement and the deck is level.

Installing on Top of a Concrete Floor

A cavity and channel must be chiseled out to accommodate the drain and waste pipe.

If the floor is not level the deck may be bedded down on tile adhesive, adjusted to level then

Pilot and screw the deck down.

Ensure there is no movement and the deck is level.

Installing the Purus Living Linear Drain - **Tiling**

The Purus Living Linear box contains some components that are not required for installation into the Maxxus Linear Deck. The only components required are as per diagram.

Waste connections can be made in the following ways:

- Access from the underneath.
- Connecting a short length of pipe to the trap to enable final connection outside the deck area.

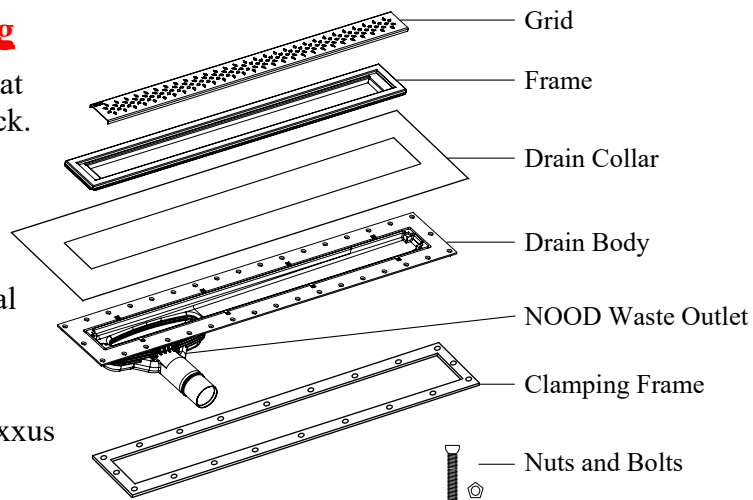

The drain body is set into the rebate from the top of the Maxxus (the side with the slopes).

The drain body is fixed into position using the clamping frame on the underside of the Maxxus and bolted through.

The bolts provided should be spaced out evenly around the drain body. Pilot drill holes through the drain body and Maxxus deck and bolt through. Do not over tighten.

Please see diagram below.

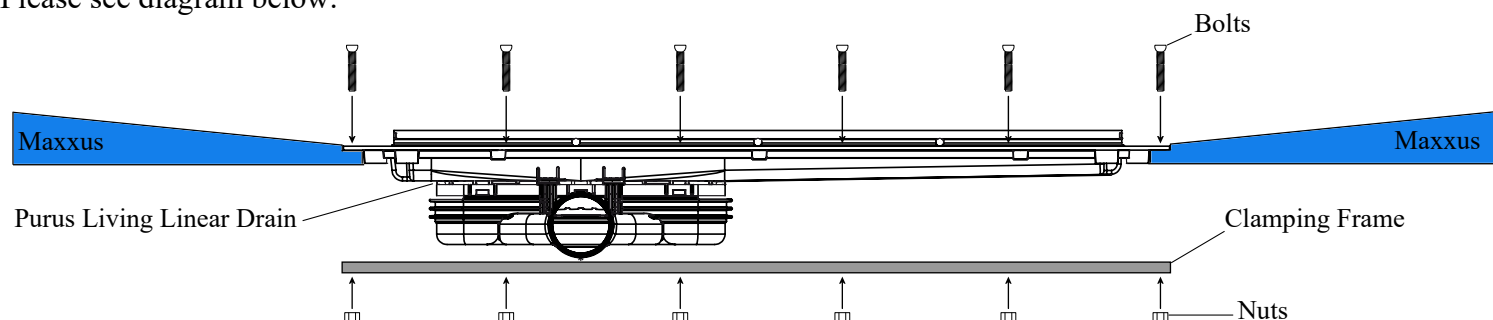

The white drain collar is laid over the top of the drain and tanked in between two coats of the paint on tanking system. The rest of the installation should also be tanked appropriately. The Maxxus should be abraded using sandpaper to provide a “key” for proper adhesion of the tanking system.

Depending how the Maxxus is installed the floor may need to be levelled to the same height as the deck, this may be done using Plywood, Screed or Tile backer board.

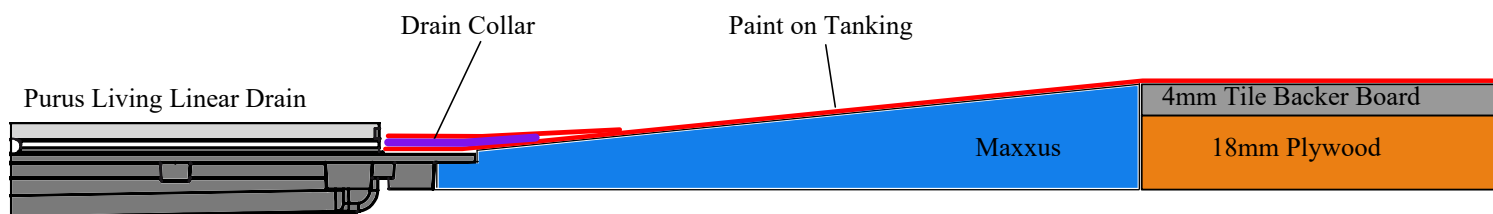

Tile up to the drain frame which will leave space for a grout line. The patterned grid and frame (Drop and Twist) can be height adjusted using the screws to accommodate different tile thickness. The tile insert grid and frame is designed to accommodate 10mm tiles.

Tile Insert

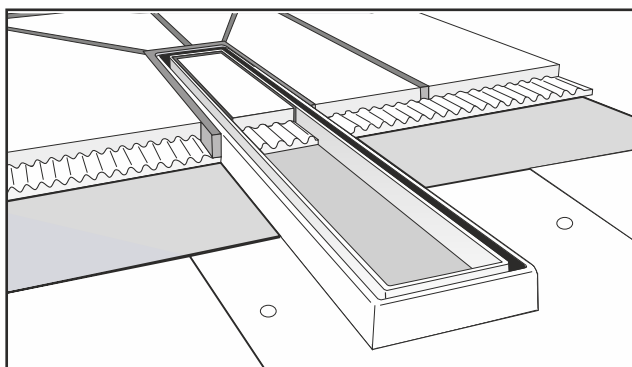

Twist Grid

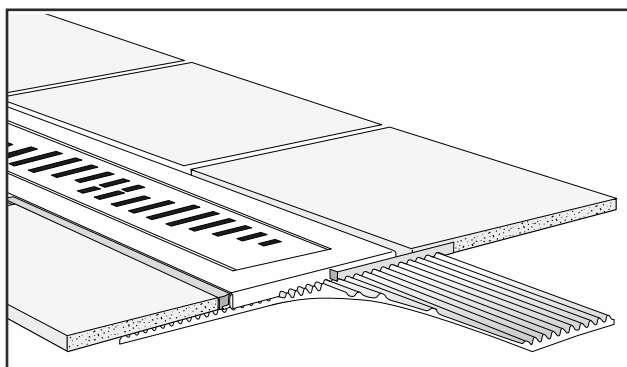

Cleaning and Maintenance

These Cleaning and Maintenance instructions must be handed to the client upon completion.

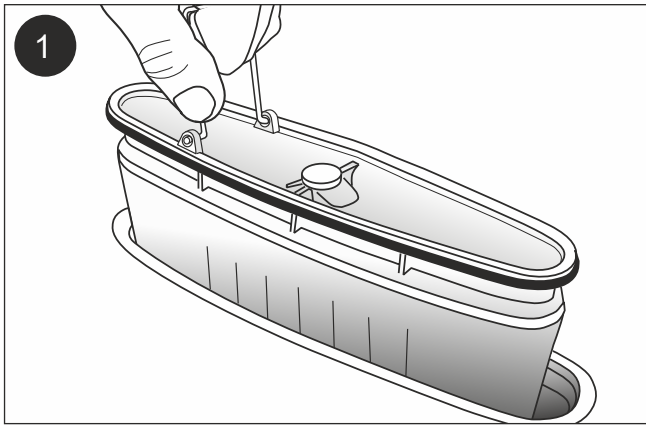

1. Lift out the NOOD water trap as above.

2. If necessary, rinse the NOOD water trap using water. Hold the NOOD water trap with the spring loaded body fully open whilst rinsed clean.

Use only water and, if required, a small brush to clean the NOOD. It is important that you do not use bleach, bleach- based, caustic cleaning products or hair dye products on or in the NOOD water trap. Remove the NOOD first.

If bleach, deblocker or any other cleaning product is to be used in the pipework, then the NOOD water trap must first be removed and bleach, deblocker or any other cleaning product poured directly into the pipework.

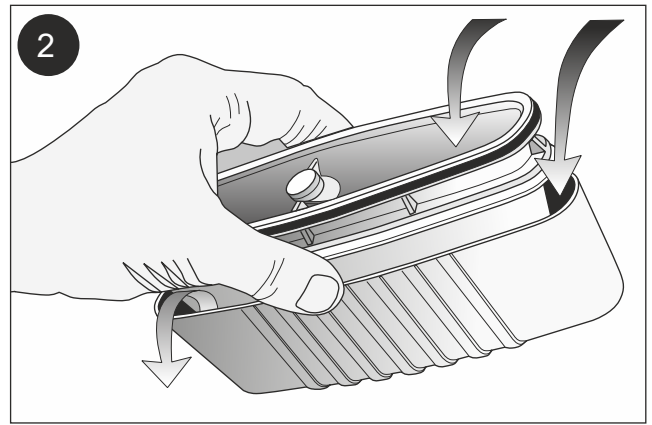

3. Replace the NOOD water trap with two thumbs at each short end.

For resealing the NOOD water trap, you will need to use a washing-up liquid around the top rubber gasket when pushing the NOOD back into position for ease of installation.

Make sure the gaskets are completely clean so the NOOD is watertight. Ensure when placed back that the gully is fully inserted so the gasket is watertight using two thumbs at each short end.

If you have a blockage in the waste pipe system, remove the NOOD before rectifying/cleaning.