

**Geberit Monolith sanitary module for wall-hung WC, 101 cm, front panel made of stoneware**

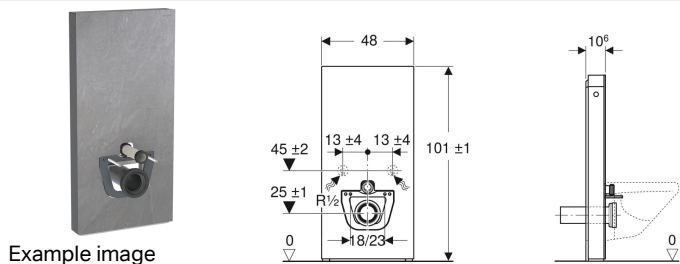

**Application purposes**

- For renovations, conversions and new buildings
- For wall inlets with inlet height > 23 cm
- For replacing low-level exposed cisterns
- For replacing wall-hung WCs with close-coupled exposed cistern
- For Geberit AquaClean WC complete solutions
- For connecting Geberit AquaClean WC enhancement solutions, with accessories
- For mounting on finished floors
- For installation in front of drywalls or solid walls
- For compensating the offset between WC connections and wall drains using a stepped straight connector for wall-hung WCs

**Characteristics**

- Dual flush
- Compensation of dimensional tolerances possible

**Scope of delivery**

- Water supply connection set with 2 angle stop valves, 1/2"
- Flush bend extension 160 mm
- Sleeve made of EPDM, ø 44 / 55 mm
- Straight connector made of PE-HD, ø 90 mm
- Adaptor socket made of PE-HD, ø 90 / 110 mm
- 2 threaded rods M12
- Base cover
- Support frame
- Fastening material for drywall
- Fastening material

- Height-adjustable up to 7 cm
- Fastening height WC ceramic appliance 35 ± 1 cm
- Cistern, fully insulated against condensation
- Side cladding made of aluminium brushed
- Self-supporting
- Adjustable flush volume
- Water supply connection on the bottom
- Water supply connection on the left/right possible with accessories

**Technical data**

Flow pressure	0.1-10 bar
Maximum operating temperature, water	25 °C
Flush volume, factory setting	6 and 3 l
Flush volume large, adjustment range	4.5 / 6 l
Flush volume small	3 l

Art. no.	Colour / surface	B	H	T
131.021.JV.5	Front cladding: Stoneware concrete look Side cladding: aluminium	48 cm	101 cm	10.6 cm
131.021.00.5	Front cladding: Stoneware slate look Side cladding: black chrome aluminium	48 cm	101 cm	10.6 cm

**Accessories**

- Geberit straight connector set for wall-hung WC, stepped by 3 cm
- Geberit straight connector set for wall-hung WC, stepped by 5 cm
- Geberit straight connector set for wall-hung WC, stepped by 7 cm
- Set of fixing bolts made of aluminium, for Geberit Monolith side cladding
- Conversion set for Geberit AquaClean WC enhancement solutions
- Lateral water supply connection set for Geberit Monolith sanitary module for WC



- The colour and structure of natural products may vary
- Sanitary modules with slate look (.00) or concrete look (.JV) are intended exclusively for use with the items under "Can be combined with"