

**Geberit Monolith Plus sanitary module for wall-hung WC, 114 cm, stoneware front cladding**

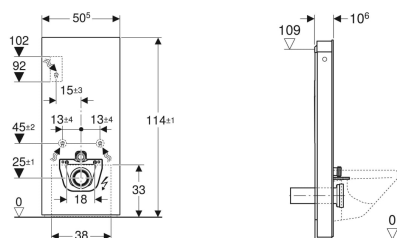

**Application purposes**

- For renovations, conversions and new buildings
- For wall inlets with inlet height > 23 cm
- For replacing low-level exposed cisterns
- For replacing half-high level exposed cisterns
- For replacing wall-hung WCs with close-coupled exposed cistern
- For replacing wall-hung WCs with pressure flushing valve
- For replacing wall-hung WCs with concealed cistern with maximum service opening height < 109 cm
- For Geberit AquaClean WC complete solutions
- For connecting Geberit AquaClean WC enhancement solutions, with accessories
- For mounting on finished floors
- For installation in front of drywalls or solid walls
- For compensating the offset between WC connections and wall drains using a stepped straight connector for wall-hung WCs

**Characteristics**

- Dual flush
- Soft-touch buttons for flush actuation
- Settings can only be changed with the Geberit Home App
- User detection range can be set
- Odour extraction with ceramic honey comb filter can be activated
- Odour extraction unit with run-on function
- Ceramic honeycomb filter for odour neutralisation can be replaced without tools
- Adjustable interval flush
- With ComfortLight
- Lighting mood infinitely adjustable from orientation light to daylight
- Light colour continuously adjustable from warm white to cool white
- DALI-compatible control
- Operation with extra-low voltage, no mains voltage in cistern

**Scope of delivery**

- Water supply connection set with 2 angle stop valves, 1/2"
- Flush bend extension 160 mm
- Sleeve made of EPDM, ø 44 / 55 mm
- Straight connector made of PE-HD, ø 90 mm
- Adaptor socket made of PE-HD, ø 90 / 110 mm
- 2 threaded rods M12
- Female socket for mains connection

- Mains connection with flexible three-core sheathed cable
- Water supply connection on the rear centre
- Water supply connection on the left/right possible with accessories
- Water supply connection on the bottom
- Compensation of dimensional tolerances possible
- Height-adjustable up to 7 cm
- Fastening height WC ceramic appliance 35 ± 1 cm
- Cistern, fully insulated against condensation
- Side cladding made of aluminium brushed
- Self-supporting

**Technical data**

Protection degree	IPX4
Protection class	I
Nominal voltage	100-240 V AC
Mains frequency	50-60 Hz
Operating voltage	12 V DC
Power consumption	15 W
Power consumption standby	≤ 0.5 W
Flow pressure	0.1-10 bar
Maximum operating temperature, water	25 °C
Flush volume, factory setting	6 and 3 l
Flush volume large, adjustment range	4-6 l
Flush volume small	3 l
Calculated flow rate	0.11 l/s
Minimum flow pressure for calculated flow rate	0.5 bar
Light colour	2200-4000 K

- Power supply unit
- Base cover
- Support frame
- Fastening material for drywall
- Fastening material
- Fastening material for installation in front of concealed cisterns

Art. no.	Colour / surface	B	H	T	
131.231.JV.7	Front cladding: Stoneware concrete look Side cladding: aluminium	50.5 cm	114 cm	10.6 cm	New
131.231.00.7	Front cladding: Stoneware slate look Side cladding: black chrome aluminium	50.5 cm	114 cm	10.6 cm	New

**Accessories**

- Geberit straight connector set for wall-hung WC, stepped by 3 cm
- Geberit straight connector set for wall-hung WC, stepped by 5 cm
- Geberit straight connector set for wall-hung WC, stepped by 7 cm
- Conversion set for Geberit AquaClean WC enhancement solutions
- Lateral water supply connection set for Geberit Monolith sanitary module for WC
- Geberit outlet mounting box
- Interface module 12 V for Geberit AquaClean Mera/Sela



- 
- The colour and structure of natural products may vary
  - Sanitary modules with slate look (.00) or concrete look (.JV) are intended exclusively for use with the items under "Can be combined with"