



Independent 4 Life

Armitage Shanks Salonex Hairdressing Kit, Manually Height ADJ - Gas Lever Control

£3,956.50 Inc. VAT

Product Code: ADJ-HAIR-001

Product Images

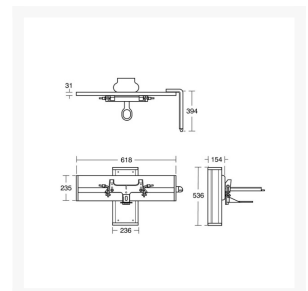
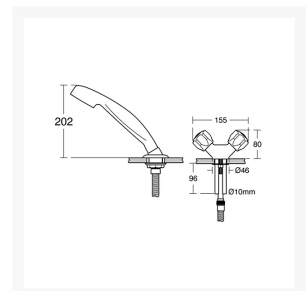
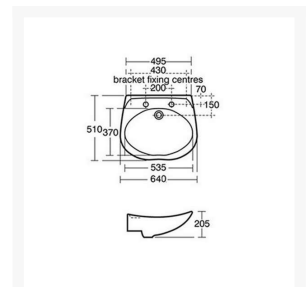



Description

The Armitage Shanks Salonex is an ergonomically shaped hairdressing basin made from vitreous china. Its clean white finish and elegant curves are matched by exceptional craftsmanship for a sturdy and stylish result.

This version of the Salonex comes as a kit for height adjustable installations.

Includes the Starlite mixer tap, hose and handset, a 1 1/4" strainer waste, flexible feed and waste kit, and a 300mm height adjustable wall mounting bracket with gas-assisted lever control.

Key benefits:

- Wall mounted hairdressing basin kit
- Pressalit PLUS height adjustable washbasin bracket, gas-assisted lever control with 300mm step-less height adjustment
- Includes washbasin, tap, hose and handset, strainer waste, flexible feed and waste kit, and concealed basin mounting bracket
- Manufactured from high quality materials by Armitage Shanks and Pressalit

Includes:

- Pressalit PLUS height adjustable gas assisted washbasin lifting system
- Armitage Shanks concealed washbasin Mounting Bracket
- Armitage Shanks Salonex 64cm Washbasin with 2 Tapholes
- Armitage Shanks Starlite Hairdresser Mixer Tap, 1500mm Hose and Handset
- Armitage Shanks Strainer Waste
- Pressalit PLUS 700mm Flexible Feed and Waste Kit - WRAS approved

Technical details:

- Total weight (kg): 23.82
- Bracket width (mm): 618
- Bracket lever length (mm): 394
- Wall track width (mm): 236
- Wall track height (mm): 536
- Basin width (mm): 640
- Basin depth (mm): 510
- Basin materials: Vitreous china
- Shower hose length (mm): 1500
- Flexible feed lengths (mm): 700
- Flexible waste length (mm): 700
- Tap, hose and handset materials: Chrome plated brass
- Strainer waste materials: Steel, chromium plated (AA), brass

Warranty:

- 5 year manufacturer warranty

Additional Information

Manufacturer	Armitage Shanks
--------------	-----------------