



Independent 4 Life

Pressalit 1200mm Flexible Feeds & 1500mm Flexible Waste System - Basin Lifts

£302.70 Inc. VAT

Product Code: R2074

Product Images

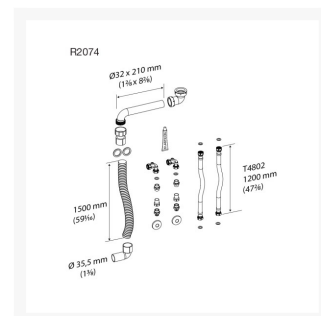
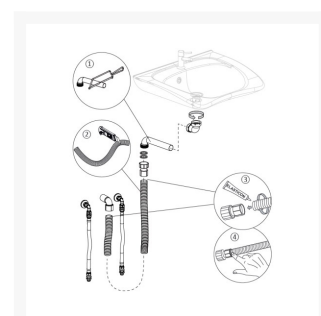

Description

Pressalit 1200mm flexible hot and cold feeds with a 1500mm flexible waste pipe for use with the Pressalit height adjustable washbasin lifts on a horizontal track for maximum movement.

The flexible feed and waste systems are needed to ensure the unrestricted flow of water to and from height

www.independent4life.co.uk | info@independent4life.co.uk | Tel: 0800 500 3001 | VAT No: 942447711

EORI GB942447711000

adjustable washbasin brackets.

It is important that the plumbing installations are correctly positioned and do not obstruct movement. The waste hose can be shortened on site if required.

Key benefits:

- Flexible feeds / waste system for the UK
- 1200mm flexible hot and cold feeds, braided stainless steel hoses with 1/2" brass couplings at either end
- 2x right-angled isolating valves for connecting to the water supply
- 1500mm flexible 32mm waste pipe with adaptor to fit to 40mm compression coupling
- Note: The 40mm waste connection will fit UK plumbing with the aid of a compression fitting (not included)
- Maximum temperatures of use are 80°C (continuous use) and 90°C (temporary use)
- WRAS approved

Materials:

- Feed pipes: SPX plastic, braided with stainless steel
- Waste pipe: Flexible, corrugated white PVC with a diameter of 32mm, supplied 40mm adaptor
- Elbow with removable connector: PP (polypropylene) with a seal of TPE (thermoplastic elastomer)
- Seal: The seal is made from EPDM

Warranty:

- 5 year manufacturer warranty

Please note:

- Pressalit recommend fitting the waste wall connection and isolating valves on the feed connections at 90° angles, pointing downwards
- Avoid the use of petroleum products and solvents with this waste kit

Additional Information

Manufacturer	Pressalit
Component	Flexible Feeds, Flexible Waste, Waste Kit - Wash Basin
Hose Length (mm) / Application	1200 & 1500 / Feeds & Waste
Technologies	Isolating Valves
Approvals	WRAS Approved