



Independent 4 Life

Pressalit 700mm Flexible Feeds & 700mm Flexible Waste System - Basin Lifts

£263.94 Inc. VAT

Product Code: R2075

Product Images

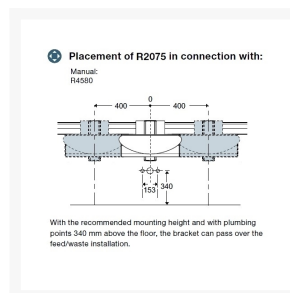
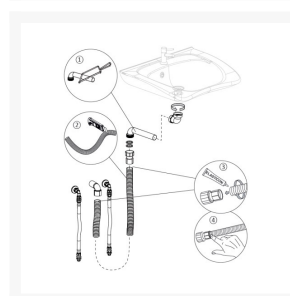
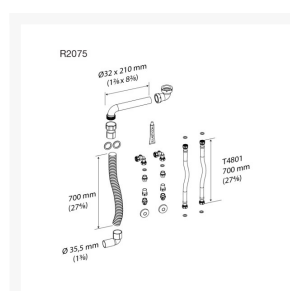



Placement of R2075 in connection with:

Electric and gas:

R4680, R4780, R4781 and R4782

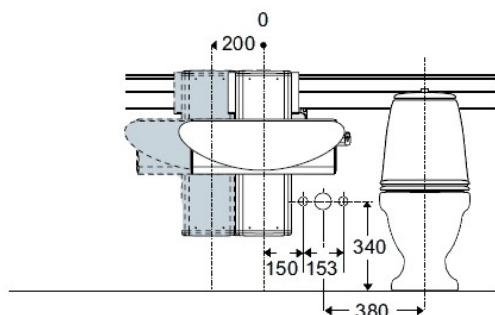

These brackets cannot pass over the feed/waste installation.



Description

Pressalit 700mm flexible hot and cold feeds with a 700mm flexible waste pipe for use with the Pressalit height adjustable washbasin lifts.

The flexible feed and waste systems are needed to ensure the unrestricted flow of water to and from height adjustable washbasin brackets.

It is important that the plumbing installations are correctly positioned and do not obstruct movement. The waste hose can be shortened on site if required.

Key benefits:

- Flexible feeds / waste system for the UK
- 700mm flexible hot and cold feeds, braided stainless steel hoses with 1/2" brass couplings at either end
- 2x right-angled isolating valves for connecting to the water supply
- Ø 32mm x 210mm overall length, waste pipe elbow (can be cut to length)
- Supplied female inlet nut with 1 1/4" to 32mm ISO Thread basin waste outlet connector
- 700mm flexible 32mm waste pipe with adaptor to fit to 40mm compression coupling
- Note: The 40mm waste connection will fit UK plumbing with the aid of a compression fitting (not included)
- Maximum temperatures of use are 80°C (continuous use) and 90°C (temporary use)
- WRAS approved

Materials:

- Feed pipes: SPX plastic, braided with stainless steel
- Waste pipe: Flexible, corrugated white PVC with a diameter of 32mm, supplied 40mm adaptor
- Elbow with removable connector: PP (polypropylene) with a seal of TPE (thermoplastic elastomer)
- Seal: The seal is made from EPDM

Warranty:

- 5 year manufacturer warranty

Please note:

- Pressalit recommend fitting the waste wall connection and isolating valves on the feed connections at 90° angles, pointing downwards
- Avoid the use of petroleum products and solvents with this waste kit

Alternative product code:

- S0649

Additional Information

Manufacturer	Pressalit
Component	Flexible Feeds, Flexible Waste, Waste Kit - Wash Basin
Hose Length (mm) / Application	700 & 700 / Feeds & Waste
Technologies	Isolating Valves
Approvals	WRAS Approved