



Independent 4 Life

# Granberg InDiago 510KA - 500-1000mm Wall Cabinet Lift (HxD) 660x260mm, Control OPT

£3,786.48 Inc. VAT

Product Code: 510KA

## Product Images

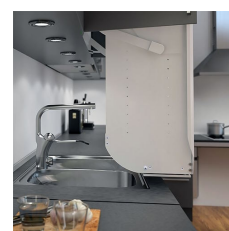

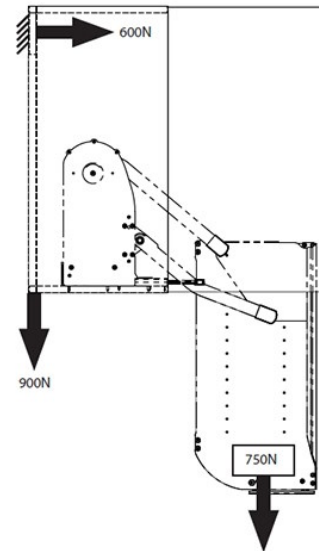
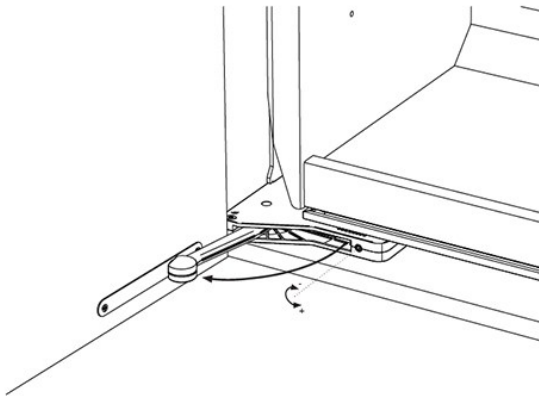
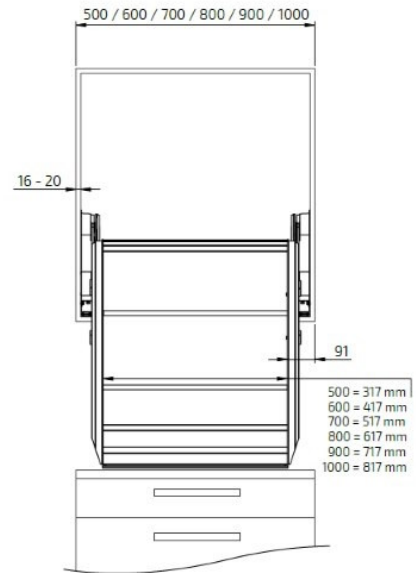
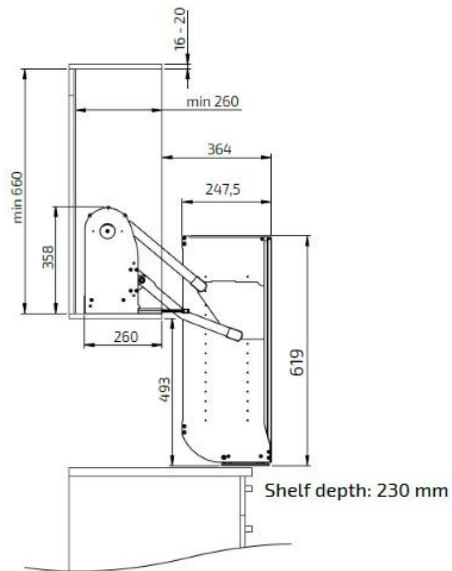



## Product Options

Cabinet Width (mm)	Price Inc. VAT
500	£3,786.48
600	£3,786.48
700	£3,786.48
800	£3,786.48
900	£3,786.48
1000	£3,786.48

## Additional Options

Standard Wired Controls	Alu-design Control Button	£0.00
	Mini Control Buttons	£0.00
Upgrade to Wireless Controls	Radio Control Mini Buttons	£165.60
	Fixed Radio Control Button, Alu-design	£165.60
	Radio Control Button, Alu-design with Extension Frame	£203.40
	Radio Remote Hand Control - Single Channel	£216.90

## Description

The Granberg InDiago 510KA is a height adjustable wall cabinet lift for the kitchen.

Fitted inside the cabinet, the lift lowers the cabinet shelves and contents in a diagonal motion to the worktop front below.

This version of the InDiago is suitable for cabinets with an internal depth of 260-309mm and an overall height of 700 to 840mm. The width of the intended cabinet can be selected above, along with a choice of control options.

### Key benefits:

- Motorised, steplessly adjustable 540mm downwards and 373mm outwards electric height adjustable wall cabinet lift
- Lowers the cabinet's shelves and contents in a diagonal motion to the worktop front below
- Shelf depth 230mm

- Quiet motors and discreet styling
- Integrated safety feature prevents the movement of the lift in the event of an obstruction
- Doors open automatically as lift is operated - doors can also be opened manually if required

#### **Choice of controls:**

- Recessed - Corded Control Button in Alu-design, with 5m Control Cable (Product Code: 61210)
- Recessed - Corded Mini Control Buttons, backlit LED, with 5m Control Cable (Product Code: 61316)
- Recessed - Wireless Mini Control Buttons, backlit LED (Product Code: 61375)
- Recessed - Wireless Control Button in Alu-design (Product Code: 61370)
- Surface mounting - Wireless Control Button in Alu-design with Extension Frame (Product Code: 61370 + 61355)
- Single Channel Remote Control (Product Code: 61395)
- Multi-channel remote controls are also available if you are installing multiple systems, contact us to discuss your requirements

#### **Integrated safety system:**

- Each lift is supplied fitted with a safety switch located below the bottom shelf
- This safety switch prevents the lift from moving if it comes into contact with an external source
- The lift also prevents movement if the doors cannot be fully opened
- An audio signal is sounded if the unit encounters any operational issues

#### **Wall cabinet requirements:**

- Cabinet width (mm): 500 to 1000mm
- Cabinet height: (mm): 700 to 840mm
- Fits cabinets with inner depth: 260 - 309mm
- For cabinet side thickness (mm): 16 - 20

#### **Technical details:**

- Mechanism height (mm): 660
- Mechanism depth (mm): 260
- For cabinet side thickness (mm): 16 - 20
- Max load (kg): 40
- Speed (mm / s): 23
- Height adjustment: Motorised, steplessly adjustable 540mm downwards, 373mm outwards
- Electrical connection: Mains plug for 230 V, max 2.5A
- Electronics and motor system "Plug and Play"
- No additional power sockets are required for the remote receiver for the Wireless and Remote Control options

#### **Materials:**

- Cabinet lifting system in powder-lacquered aluminium (white)
- Back and ceiling of HDF. Shelves of white melamine (16mm)
- Powder-lacquered sheet metal parts (white)

#### **Warranty:**

- 2 year manufacturer warranty

#### **Manufacturer product codes:**

- 510KA-050, 510KA-060, 510KA-070, 510KA-080, 510KA-090, 510KA-100

#### **Please note:**

- Please note, the InDiago is not compatible with an “In-frame” wall cabinet, the mechanism will collide with the front frame.

## Additional Information

Manufacturer	Granberg
Model	InDiago 510
Style	Cabinet Shelves Lower to User
Max. Distance Lowered (mm)	540
For Cabinet Width (mm)	500, 600, 700, 800, 900, 1000
For Cabinet Height (mm)	700, 800
For Cabinet Depth (mm)	260 - 309 (Internal)
Max. Load (kg / St)	40 / 6.3