



Independent 4 Life

# AWS Grooved Low-profile AL Door THR 152 W x 6.4 H - Choice of Length 914 to 3048mm

From: £75.64  
To: £677.84  
Inc. VAT

Product Code: 4LA840021

## Product Images



Suggested Installation

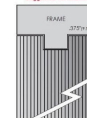

- 1 Measure and cut threshold to size as required.
- 2 Notch as necessary, to suit door frame.
- 3 Caulk underneath and around edges of threshold for moisture control.
- 4 Attach threshold to floor surface with screws provided.

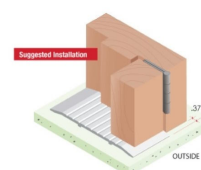



# Product Options

Width x Height x Length ft / mm



**152 W x 6.4 H x 3ft / 914mm L** £63.03

152.4mm wide x 6.4mm high, medium duty aluminium mill finished low-profile flat door saddle threshold, suitable for internal and external doors - 914mm / 3ft length.

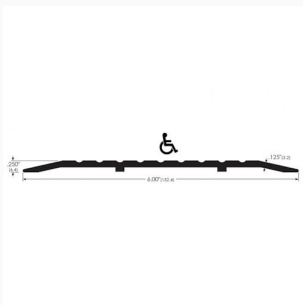

**152 W x 6.4 H x 4ft / 1219mm L** £79.68

152.4mm wide x 6.4mm high, medium duty aluminium mill finished low-profile flat door saddle threshold, suitable for internal and external doors - 1219mm / 4ft length.

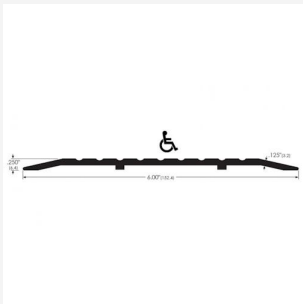

**152 W x 6.4 H x 6ft / 1829mm L** £112.98

152.4mm wide x 6.4mm high, medium duty aluminium mill finished low-profile flat door saddle threshold, suitable for internal and external doors - 1829mm / 6ft length.

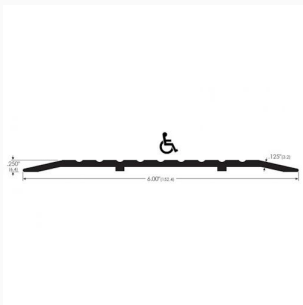

**152 W x 6.4 H x 7ft / 2134mm L** £129.63

152.4mm wide x 6.4mm high, medium duty aluminium mill finished low-profile flat door saddle threshold, suitable for internal and external doors - 2134mm / 7ft length.



**152 W x 6.4 H x 10ft / 3048mm L** £179.53

152.4mm wide x 6.4mm high, medium duty aluminium mill finished low-profile flat door saddle threshold, suitable for internal and external doors - 3048mm / 10ft length.

# Description

152mm wide aluminium door threshold, designed to stand up to the demands of medium duty traffic as well as temperature extremes.

Low flat threshold at only 6.4mm in height.

The 3.2mm thick aluminium allows you to drill and screw the threshold into concrete without the difficulties you are likely to find using lighter materials - such as buckling under heavy loads or loose fixing screws.

## Key benefits:

- Aluminium mill finish
- Grooved top
- Simple to install
- Supplied un-drilled
- Suitable for DDA applications
- Ideal for commercial and domestic installations
- Non flammable

## Technical details:

- Choice of Length: 914mm (3 ft), 1219mm (4 ft), 1829mm (6 ft), 2134mm (7 ft) and 3048mm (10 ft)
- 152.4mm / 6.0" wide
- Height: 6.4mm (0.25")
- Material: 3.2mm (0.125") thick medium gauge aluminium
- Corrosion: Successfully tested to Grade 4 (240 hours neutral salt spray exposure) in accordance with BS EN 1670:2007 Building Hardware

## Installation Instructions:

- Measure and cut threshold to size as required
- Notch as necessary, to suit door frame
- Caulk underneath and around edges of threshold for moisture control

# Additional Information

Manufacturer	AWS
Application	6.4mm Low-profile
Length (mm / feet)	914 / 3', 1219 / 4', 1829 / 6', 2134 / 7', 3048 / 10'
Width (mm / inches)	152.4 / 6"
Supplied Pre-drilled	No