



Independent 4 Life

Inta Infrared Wall Mounted Tubular Tap 170mm Length (9V Battery Box)

£305.35 Inc. VAT

Product Code: IR270CP

Product Images

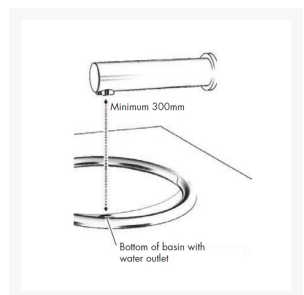
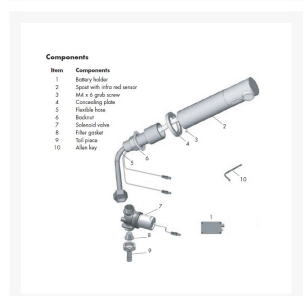
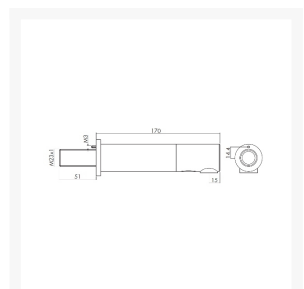

Description

This Intra wall mounted tubular infrared tap delivers water without contact with the tap, with a 170mm projection length.

An ideal solution where hygiene is paramount, such as in public toilets and washrooms, where vandal resistance is required.

To avoid reflection problems keep a distance of more than 300mm between the basin and spout, this tap is not suitable for use with reflective sinks i.e. stainless steel.

Key benefits:

- Infrared
- Vandal resistant
- Hygienic
- Water saving
- Programmable flow time
- Self adjusting sensor
- Manual temperature adjustment
- Operating pressure range of 0.5 to 8 bar
- Use with a pressure reducing valve in excess of 8 bar
- Security shut off after 90 seconds
- Requires 6x 1.5V AA batteries (not included)
- Self-opening after last water flow: Every 24 hours
- 6 litre per min flow regulator
- Includes an aerator that allows the water stream direction to be adjusted to prevent water splashing

Technical details:

- Spout length (mm): 170
- Min. Inlet pressure dynamic: 0.5 bar
- Max. Inlet pressure static: 8 bar
- Max. Inlet temperature: 70°C
- Inlet connections: 10mm Spigot
- Min. Sensor range: 80mm
- Max. Sensor range: 300mm
- Security time: 90 seconds - can be reduced with a *Remote control
- Remote control available separately if required, to adjust detection range and timed flow rate
- Power specification: 9V
- When the battery power is low and about to run out, the red indicator light will blink at a constant rate when the user's hands are within the sensor range
- The batteries must be replaced within two weeks
- Not suitable for installations, where freezing is likely

Approvals:

- WRAS approved

Warranty:

- 1 year manufacturer warranty

Note:

- To limit the outlet temperature to 41°C max. use the Intamix Thermostatic Mixing Valve (Product Code 40015CP).

Additional Information

Manufacturer	Inta
Application	Basin
Tap Style	Spout, Wall Mounted Valve
Mounting	Wall
Operation	Infrared
Vandal Resistant	Yes
Water Pressure	Low, Normal Mains, High Pressure Systems
Approvals	WRAS Approved
Technologies	Self Adjusting Sensor, Aerator Outlet, Water Saving, TMV a Recommended Extra, Programmable Flow Time, Battery Operated, Vandal Resistant