



Independent 4 Life

Granberg Basicline 406-1 Gas Sprung Height ADJ Washbasin Bracket

£1,005.24 Inc. VAT

Product Code: 406-1

Product Images

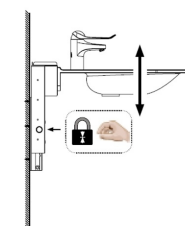
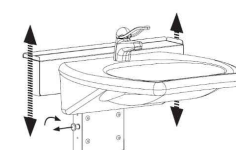
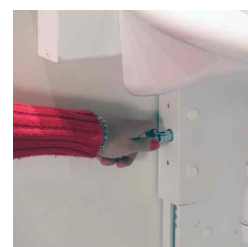

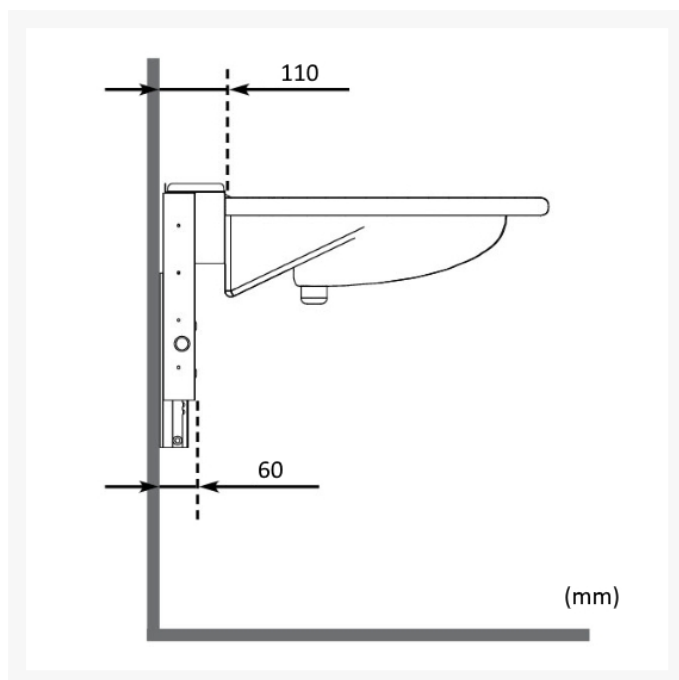
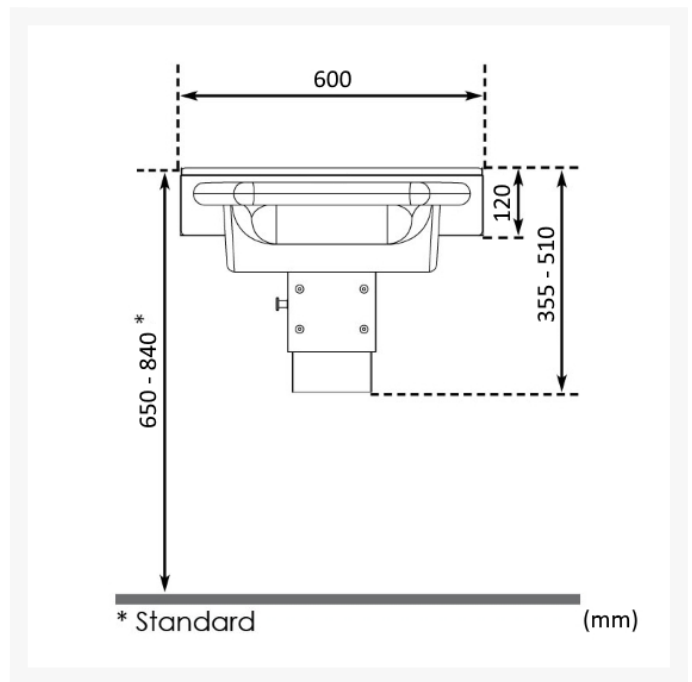
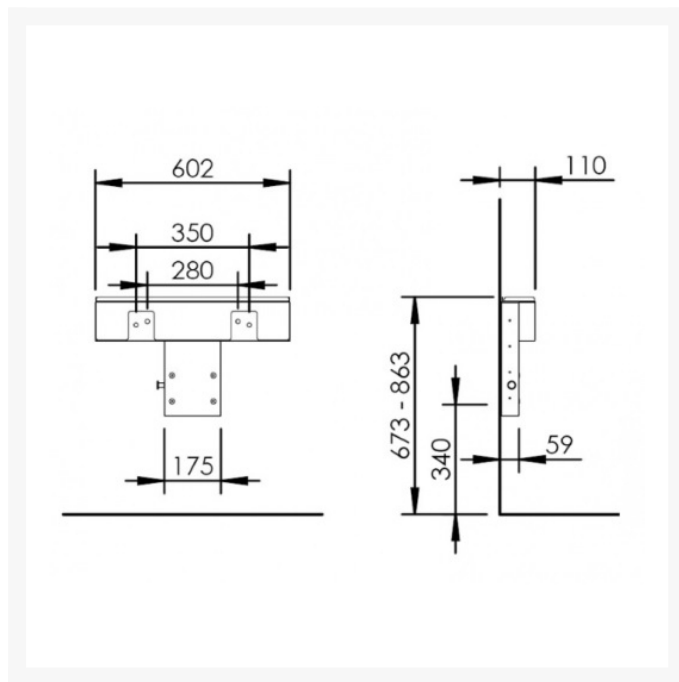

Description

The Granberg Basicline 406-1 is a height adjustable bracket mount for washbasins.

Manually adjustable with gas spring assistance, it is ideal for situations where the height is only occasionally adjusted.

Key benefits:

- Height adjustable bracket for basins
- Manual operation with gas assisted spring - for occasional height adjustments
- Bracket provides 190mm of adjustment in 12mm increments
- Practical storage shelf behind the washbasin 120mm deep

- Free space below the unit for plumbing connections
- Low level (can be installed beneath a mirror or cabinet)
- The system can be completed with a washbasin, tap, 500mm flexible feeds and waste kit (available separately)

Technical details:

- Total width (mm): 602
- Height adjustment range (mm): 190
- Height of wall bracket (mm): 120
- Depth of wall bracket (mm): 110
- Basin centre-to-centre fixings (mm): 280 or 350
- The adjustment toggle, is left hand mounted (this cannot be changed)
- Note: Assistance is required to push the rear of the basin on the downward stroke

Washbasin:

- Max weight (kg): 12-18
- Max width (mm): 600
- Max depth (mm): 600
- Basin centre-to-centre fixings (mm): 280 or 350

Warranty:

- 2 year manufacturer warranty

Additional Information

Manufacturer	Granberg
Bracket Range	Granberg BASICLINE 406
Bracket Operation	Gas Assisted
Bracket Adjustment	Manual Pull-out Button
Height Adjustment (mm)	190
For Wash Basin Range	BASICLINE 425-001, BASICLINE 425-003, BASICLINE 425-010, BASICLINE 425-011, BASICLINE 425-015
Bracket Mounting	Wall
Safety Stop	No