



Independent 4 Life

# Kessebohmer iMove Pull-down Shelves, 500mm Wall CAB 2 Tier - Anthracite

£329.63 Inc. VAT

Product Code: KIMOVE500DA

## Product Images

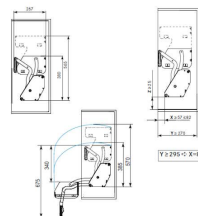

OPEN



CLOSE



## iMove lock function

© KESSELHIMMEL



Example shows 1 Tier Max. 8kg.  
(2 Tier Max. 4 + 4 Kg = 8kg)





## Additional Options

Optional - iMove extension handle	Extension Handle - 300x124x15mm	£38.83
-----------------------------------	---------------------------------	--------

## Description

The Kesseböhmer iMove range has been designed with style in mind. A perfect way to access any wasted space in high cabinets.

The iMove range is a sleek and minimalistic way to bring items down to a reachable level for a standing user.

**Please note** this product is not designed to be used by people in a seated position.

### Key benefits:

- Pull-down 2 tier trays for wall cabinets
- Grab handle, below the bottom tray
- Drop-down height of 340mm
- Concealed hinges
- Metal frame with anthracite powder coated finish
- Optional extension handle to increase reach range - 300x124x15mm

### iMove Lock Function:

- To reach the lowest loading position, the user must swing the fitting over a certain resistance
- This allows the fitting to engage and stay in the holding position
- Delivered factory set at the lightest level
- If the unladen tray disengages from the holding position, the user can increase the holding force using the switch

- Note: Adjusting this lever does not change the permitted maximum load.

**Technical details:**

- Number of trays: Two
- For wall cabinet width (mm): 500
- Minimum clear internal cabinet depth required (mm): 267
- Height (mm): 565
- Tray drop down height / minimum height required from worktop (mm): 340mm
- Tray width (mm): 456
- Maximum load per tray (kg): 4
- Finish: Powder coated
- Materials: Metal
- Finish: Anthracite

**Note:**

- The wall cabinet must be securely fixed to the wall
- Some physical effort is required to pull down these shelves, particularly when empty
- Important: The drilling pattern supplied with product must be used - failure to do so may cause fitting issues
- For cabinets with a door, we recommend the fitting of 110° hinges (not included) to allow unobstructive movement of the mechanism

**Manufactures Warranty**

- Kesseböhmer 10-year warranty

**Additional Information**

Manufacturer	Kesseböhmer
Max. Distance Lowered (mm)	340
Number of Tiers	Two Tier
For Cabinet Width (mm)	500
Frame Colour	Anthracite