



Independent 4 Life

# Methven Kiri MK2 Cool to Touch Bar Shower with Diverter

£433.68 Inc. VAT

Product Code: KRCTADEF

## Product Images

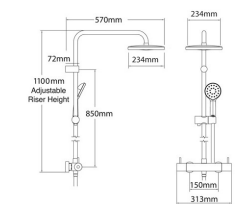
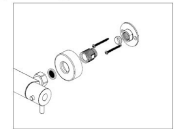
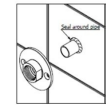

KRCTADEF						
Open Outlet Flow (Bar - l/min)						
Bar	0.5	0.6	1.0	2.0	4.0	5.0
HANDSET FLOW	9	9	9	9	9	9
OVERHEAD FLOW	9	9	9	9	9	9

Please Note: Flow rate will be dictated by installation configurations. Please ensure to check the appropriate flow restrictor information if applicable.

# Description

---

The Kiri MK2 cool to touch bar shower makes a statement with its crisp, sleek and modern design. It is easy to operate valves with ceramic discs, with dual outlets switching between the Kiri Satinjet hand shower and Satinjet overhead soaker.

This version of the Kiri cool to touch bar shower features an 1100mm height adjustable riser rail for greater flexibility.

The water flow rate has been developed to be water efficient, without compromising on water efficiency. Designed to provide you with the maximum comfort, and all-over warmth.

The Satinjet overhead rain shower and Kiri Satinjet hand shower, both use unique twin-jet technology to create the perfect water pressure and water droplet size, creating over 300,000 water droplets per second.

The thermostatic mixer bar is cool-to-touch, ideal for families with varying showering abilities.

## Key benefits:

- Divert between full body overhead or handset
- Thermostatic shower with height adjustable riser and Satinjet overhead soaker
- Kiri Satinjet hand shower, with adjustable holder
- Easy-fit connectors - For quick and simple installation
- Advanced and efficient shower system saves on water
- 1.5m twist-free smooth hose - Easy to use and to clean
- Water efficient without compromising performance
- Suitable for High/Mains Pressure
- ¼" Easy turn peg lever controls
- Ceramic discs

## Safety features:

- Valve is safe and cool to touch making it ideal for families
- Cool-to-touch technology - Ensures the bar valve never gets warmer than the mixed water temperature
- Thermostatic control - Maintain your preferred temperature setting
- Separate flow and temperature controls
- 38°C temperature hot stop with override facility
- Anti-scalding - water is prevented from reaching a temperature hot enough to scald

## Approvals:

- TMV2 approved
- Kiwa approved
- WRAS approved

## Technical details:

- Projection from wall (mm): 72
- Height adjustable riser rail height (mm): 1100
- Handset range of movement (mm): 850
- Satinjet overhead shower projection from wall (mm): 570
- Satinjet overhead shower diameter (mm): 234
- Inlet connections (mm): 15 Compression
- Outer edge of bar shower (mm): 313
- Min inlet pressure (bar): 1.0

- Max inlet pressure (bar): 5
- Factory pre-set temperature: 38°C

**Warranty:**

- 5 Year manufacturer warranty

## Additional Information

---

Manufacturer	Methven
Shower Type	Direct Fed (Mixer)
Shower Features	Thermostatic Mixers, Shower Valves with Diverters, Shower Control, Fixed Riser Rail, Flexible Hose and Handset, Shower Head Holder, Overhead Soaker
Fixings	Exposed
Control	Manual Lever, Manual Dial
Hose Length (mm) / Application	1500 / Shower Hose
Water Pressure	Normal Mains, High Pressure Systems
Technologies	Thermostatic Control, Satinjet, Safe Touch, Temperature Control Lever, Water Saving, Ceramic Disc, Easy-fit Connectors
Approvals	WRAS Approved, Kiwa Approved, TMV2 (Domestic Sector)