



Independent 4 Life

AKW iTherm White 9.5kW Thermostatic Shower w/ Standard Kit

£219.78 Inc. VAT

Product Code: 29025

Product Images



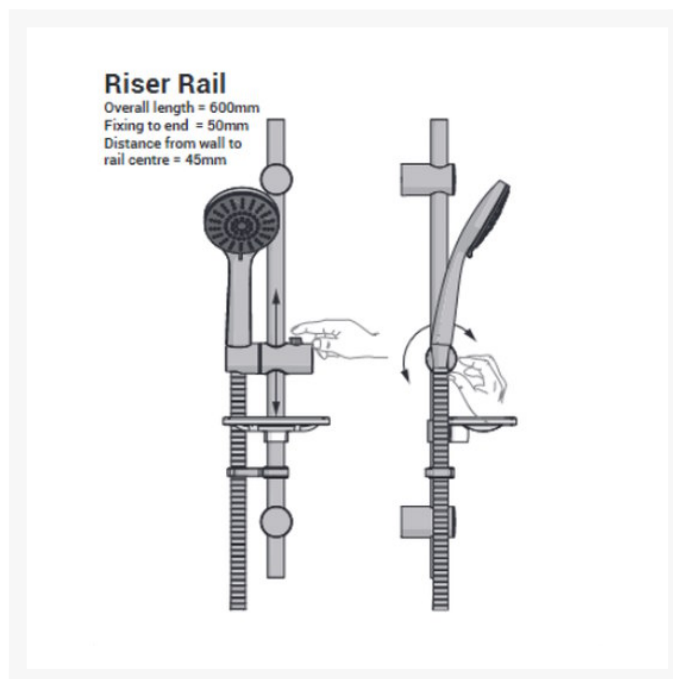

Description

The AKW iTherm 9.5kW thermostatic shower, with a standard riser rail kit. Expertly designed, an electric shower encompassing a multitude of features designed to aid with personal or assisted showering. Features, such as the LED indicators for the temperature and flow that assist with visual impairments, thermostatic maximum temperature protection and thermostatic temperature stability.

The shower has also been designed to assist the installer with simple but thoughtful features such as 8 different electric and water entry points, dual power blocks for right or left-hand wiring and a footprint that covers most manufacturer models; this reduces the chances of having to re-tile if retrofitting.

Key benefits:

- Super-quick and easy installation
- Electronic thermostatic Temperature and Flow Control
- Independent LED Temperature and flow Indicator and controls
- Thermostatically Stabilised Temperature
- Maximum water temperature protection
- Easy push Power button maintaining Temp/Flow settings
- Automatic shutdown time of 30 minutes
- Rounded surfaces for added safety if the user falls in the shower
- Chromed 600mm standard adjustable riser rail kit
- Includes a 3 mode shower head
- 1500mm shower hose
- Soap Dish
- No re-tiling required, ideal for refurbishment work

Product compatibility:

- All AKW digital and manual shower pumps
- Wireless pumped interface
- Suitable for AKW M Series, (flow sensor) or AKW A4 (flow switch)

www.independent4life.co.uk | info@independent4life.co.uk | Tel: 0800 500 3001 | VAT No: 942447711

EORI GB942447711000

- iShower app for Android and iPhone

Technical details:

- Output (kW): 9.5
- Supply Fuse/Circuit Breaker: 40/45 amp
- Terminal block connections: Max. 10mm²
- 8 cable entry points: top, bottom, rear and side and left or right
- Supply: Mains pressure cold water only
- 8 water entry points: top, bottom, rear and side and left or right
- Inlet connections: 15mm compression
- Outlet connection: ½" BSP male thread fitting
- Minimum maintained pressure: 0.5 bar
- Maximum pressure: 10.0 bar
- Riser rail (mm): 600
- Fixing to end (mm): 50
- Distance from rail to centre (mm): 45
- Hose length (mm): 1500
- 3 mode, lever twist shower head

Approvals:

- WRAS Approved
- BEAB Care Approved
- BEAB Approved

Manufacturer warranty:

- 5 year manufacture warranty

Additional Information

Manufacturer	AKW / Contour
Shower Type	Electric
Shower Features	Thermostatic Mixers, Shower Head, Shower Control, Adjustable Riser Rail, Flexible Hose and Handset, Shower Head Holder, Waste Water Pump Link
Fixings	Concealed
Control	Manual Dial, Push Button, Smart Phone App (Android or iPhone)
Hose Length (mm) / Application	1500 / Shower Hose
Water Pressure	Normal Mains
Technologies	Thermostatic Control, Phased Shutdown, Temperature Adjustable
Approvals	BEAB Approved, UKCA Mark, CE Mark, WRAS Approved