



Independent 4 Life

Pressalit MATRIX CURVE Ergonomic Wash Basin with Overflow - 600x490mm

£579.30 Inc. VAT

Product Code: R2050000

Product Images

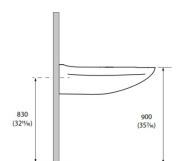
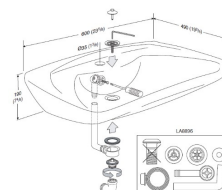
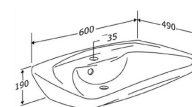

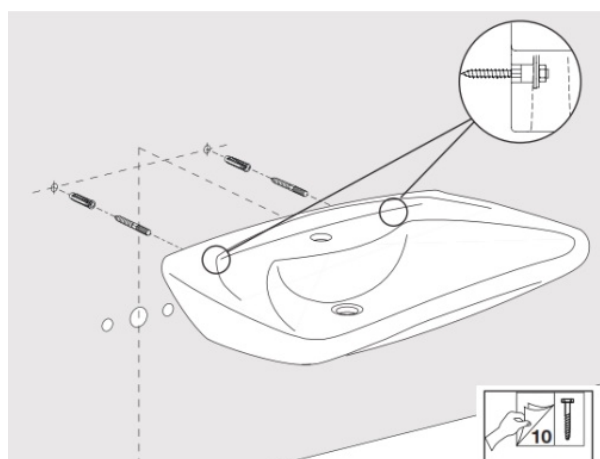
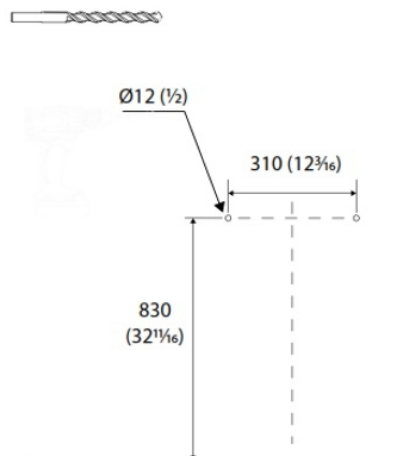
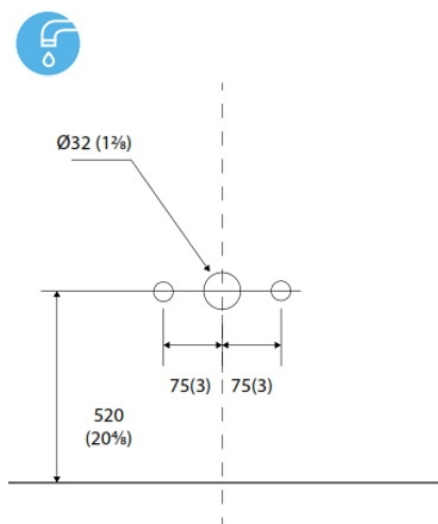

Description

Pressalit MATRIX Curve ergonomic washbasin with overflow and one tap hole.

The concave front edge stabilises both standing and seated users.

The rounded edges are also comfortable to hold and rest against.

Key benefits:

- Ergonomic design stabilises standing and seated users
- Sleek, rounded design facilitates easy cleaning
- Shallow enough to give seated users the leg-room they need

- Suitable for height adjustable installations
- User friendly plug with toggle for ease of use
- With tap hole: Ø 35mm and overflow
- Can be mounted on height adjustable brackets from the Pressalit Value, Plus and Select ranges
- Can be wall mounted
- Easy to clean

Technical details:

- Width (mm): 600
- Front-to-back depth (mm): 490
- Overall height (mm): 190
- Centre-to-centre of bolt fixings (mm): 280
- Tap hole diameter (mm): 35
- Weight (kg): 16.6
- Maximum load (kg): 200

Warranty:

- 5 year manufacturer warranty

Additional Information

Manufacturer	Pressalit
Range / Model - Type	VALUE / R1210 - Man., VALUE / R1214 - Man., PLUS / R4550 - Man., PLUS / R4580 - Man., PLUS / R4650 - Gas, PLUS / R4680 - Gas, PLUS / R4681 - Elec., PLUS / R4682 - Elec., PLUS / R4750 - Elec., PLUS / R4751 - Elec., PLUS / R4752 - Elec., PLUS / R4780 - Elec., SELECT / R4950 - Elec., SELECT / R4951 - Elec., SELECT / R4952 - Elec., SELECT / R4953 - Elec.
Compatible Height Adj. Bracket	Pressalit PLUS, Pressalit SELECT, Pressalit VALUE
For Wash Basin Range	MATRIX Curve
Width (mm)	600
Front-to-back depth (mm)	490
Overall height (mm)	190
Overflow	Yes
Integrated Grabrails	No