



Independent 4 Life

Granberg 425-003 Ergonomic Wash Basin, Tap Hole, Overflow - 550x550mm

£779.76 Inc. VAT

Product Code: 425-003

Product Images

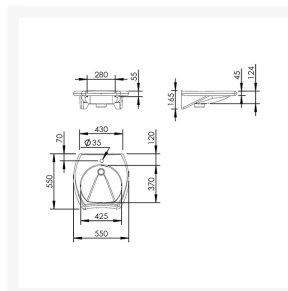
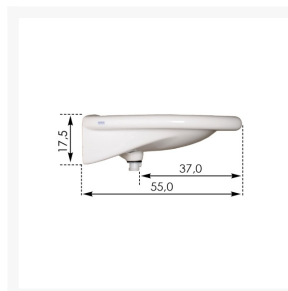



Description

The Granberg 425-003 is an ergonomic wheelchair accessible washbasin with a shallow bowl, concave front edge and easy-to-grip sides.

The shape of the basin and position of the waste allow for easier use for seated and wheelchair users.

Manufactured by Geberit from high quality porcelain, the basin has an overflow and is supplied with a bottom drain, waste and plunger plug.

Key benefits:

- Ergonomically shaped basin with a concave front edge 45mm thick to assist wheelchair and seated

users

- Easy-to-grip sides 55mm thick
- Rear positioned waste allows for maximum leg room under the basin
- Supplied with overflow and bottom waste and plunger plug

Technical details:

- Width (mm): 550
- Front-to-back depth (mm): 550
- Front height of basin (mm): 124
- Rear height of basin (mm): 165
- Leg room beneath the basin (mm): 550mm
- Centre-to-centre of bolt fixings (mm): 280
- Tap hole diameter (mm): 35
- Weight (kg): 16.04
- Maximum load basin (kg): 100
- Materials: Porcelain

Warranty:

- 2 year manufacturer warranty

Additional Information

Manufacturer	Granberg
Range / Model - Type	BASICLINE / 401 - Man., BASICLINE / 403 - Man., BASICLINE / 406 - Gas, BASICLINE / 415 - Elec., BASICLINE / 433 - Elec., DESIGNLINE / 417 - Elec.
Compatible Height Adj. Bracket	Granberg BASICLINE 401, Granberg BASICLINE 403, Granberg BASICLINE 406, Granberg BASICLINE 415, Granberg DESIGNLINE 417, Granberg BASICLINE 433
For Wash Basin Range	BASICLINE 425-003
Width (mm)	550
Front-to-back depth (mm)	550
Overall height (mm)	165
Overflow	Yes
Integrated Grabrails	No