



Independent 4 Life

# Royde & Tucker Emergency Release Door Stop, Holdback, Plunger Style - Satin SS

£108.02 Inc. VAT

Product Code: H131-106

## Product Images

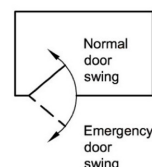
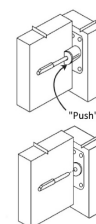
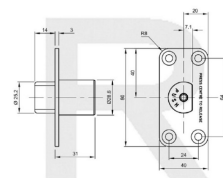

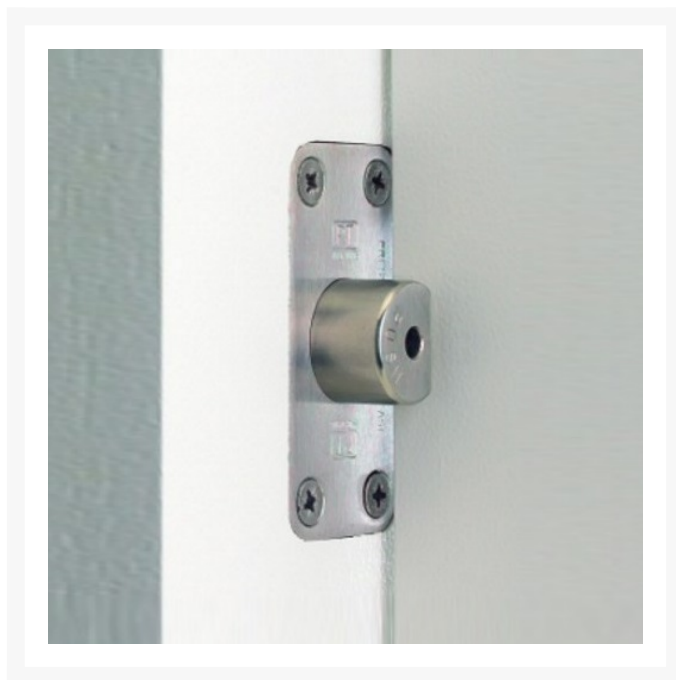
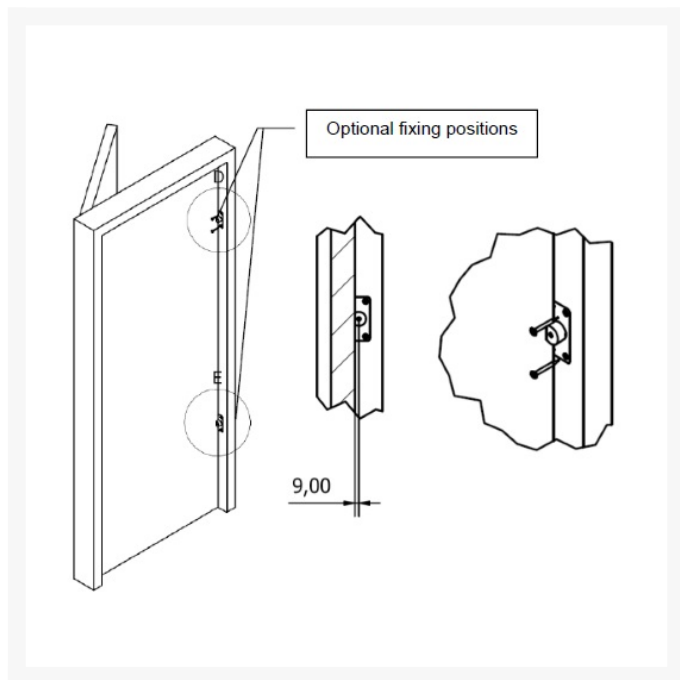

## Description

---

An Emergency Release functions as the door stop in normal day-to-day use, but can be either depressed in the event of an emergency, therefore allowing the door to be swung outwards to gain access.

Typical installations are in healthcare whereby the stop can be removed to gain emergency access if, for example, a patient has collapsed against the back of the door.

It could also be used in some situations as an anti barricade device.

All emergency releases require the door to be operable in both directions, therefore the door must be hung on a pivot or floor spring.

- Allows double action door to operate as a single swing when hung on a pivot door hinge
- Emergency access is gained by depressing the stop and pulling the door outward
- Includes holdback facility
- Stop release resets automatically
- Suitable for use on FD30 and FD60 fire doors
- Maintenance free - 25 year manufacturer guarantee
- Plate has R8 radius for easier installation
- 5x 30mm screws included
- Grade 304 stainless steel
- Satin finish

### Warranty:

- 25-year manufacturer warranty

### Also available separately:

- Pivot Door Hinges - Which allow the door to swing in either direction
- Brush strips - it is recommended that both lock and hinge stiles are brush stripped for privacy

# Additional Information

---

Manufacturer	Royde & Tucker
Suitable For FD30 / FD60 Fire Doors	Yes